

AMAL MK2 CARBURETTERS

2000 & 2900 Series of Concentric Carburetters

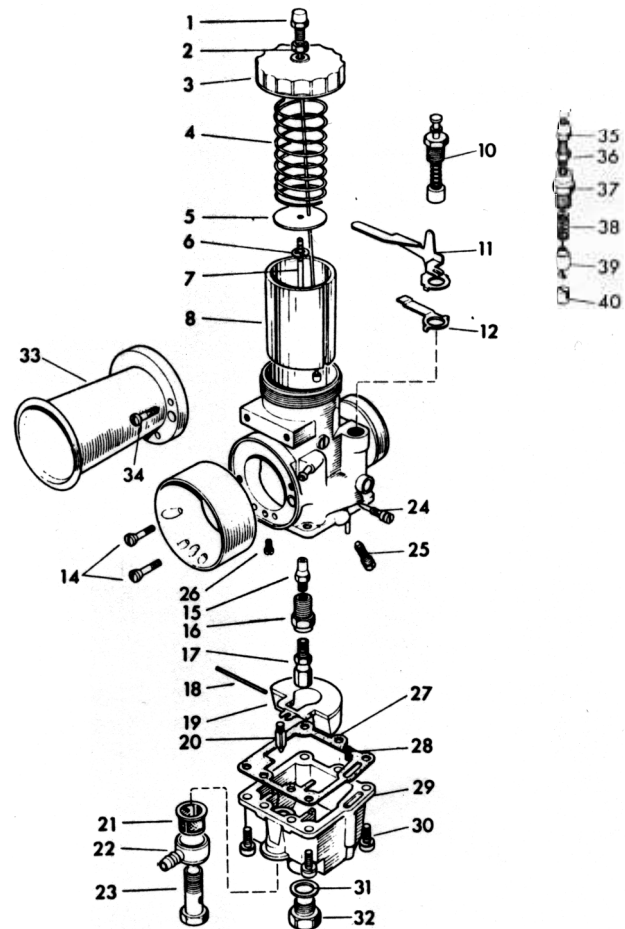
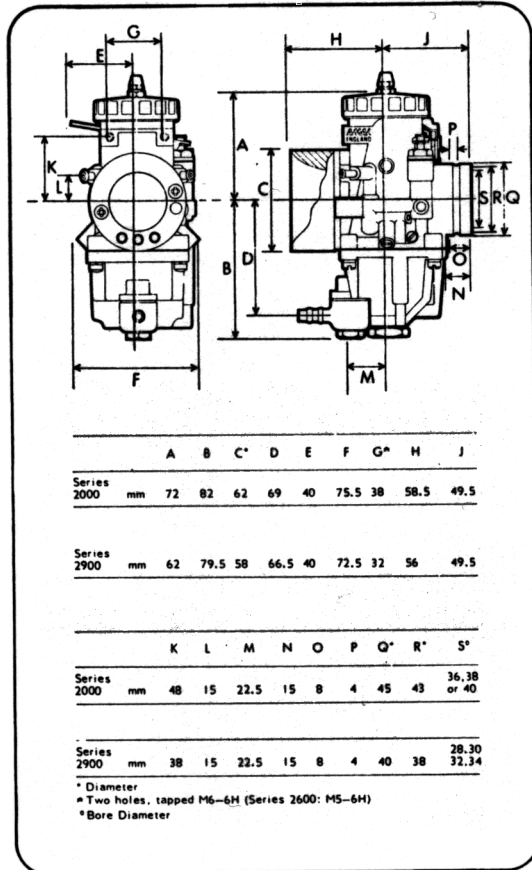

MARK 2 RANGE OF AMAL CONCENTRIC CARBURETTERS

Developed from the well-known Mark I Amal Concentric, the Mark 2 range has been designed to meet the exacting performance requirements of modern motorcycles.

The Mark 2 range is available in 2 body sizes giving an option of 3 bore diameters from 32 to 36 mm. The body and other component parts are precision die-cast in aluminium alloy. A number of extra features are incorporated:

The smoothly contoured tract shape of the air intake tube tapers concentrically straight into the carburettor-bore, giving improved air flow and greater engine power output. The cold-starting mixture-enrichment device is operated by a lever mounted directly on the carburettor body. An alternative arrangement with cable control from the handlebar, or elsewhere on the machine is also available (as illustrated on this page). The carburettor is designed for flexible mounting, giving excellent insulation from vibration on modern high-speed high-performance engines. A screw-off top to the mixing chamber allows quick and easy servicing and tuning, two float-chamber vent tubes mounted high up on the carburettor body prevent fuel spillage under extreme conditions.