

TRIUMPH

MOTOR CYCLE

REPLACEMENT PARTS

1946

MODELS

TIGER 85

TIGER 100

3T DE LUXE AND SPEED-TWIN

British Only

MOTORCYCLES AND PARTS INC.

32451 PARKLANE ST. WWW.BRITISHONLY.COM
GARDEN CITY, MI 48135 USA INFO@BRITISHONLY.COM

RETAIL: 1-800-278-6659

WHOLESALE: 1-800-852-9253

FAX: 1-734-422-9253

WORLDS LARGEST SELECTION OF FACTORY ORIGINAL NEW AND USED PARTS

45,000 SQ. FT. OF MOTORCYCLE PARTS & ACCESSORIES FROM 1911 TO 1984 FOR ALL BRITISH MAKES!

CASH FOR ALL BRITISH BIKES, PARTS AND LITERATURE

SPECIALIZING IN
VINTAGE MOTORCYCLE PARTS

TRIUMPH

Norton

BSA

THE BIGGEST!

ENGINE REBUILDING PARTS
GASKET - SEALS - BEARINGS
BUSHINGS - PISTONS - RINGS
CLUTCHES - TUNE UP PARTS
SPEED EQUIPMENT

THE BEST!

STOCK AND CUSTOM PARTS
SEATS - HANDLEBARS - CHAINS
TIRES - TUBES - EXHAUST PIPES
MUFFLERS - GAS TANKS - FENDERS
RESTORATION PARTS

THE ONLY!

**Central Wheel
Components**

Barnett
Clutches & Cables

**CLASSIC
TRANSFERS**
ROBERT DERRICK LTD

RENOLD

Lucas

AMAL

IEMIGO.
Your Powersport Supplier

BRITURO
ENGLAND

JP PISTONS

HASTINGS

UH

VELOCETTE • ANDOVER NORTON • TEC • HAYNES • P&P SEATING • WASSELL • MORG
ALPHA BEARINGS • M.A.C. PRODUCTS • JOE HUNT MAGNETOS • J.J. CABLES • BUCHANAN'S
L.A. SLEEVE • MEGACYCLE CAMS • T.J. WASSELL LIMITED • SUDCO INTERNATIONAL
ACE CLASSICS LONDON • CLASSIC GASKETS • BRITISH WIRING • PBM ENGINEERING
TRI-COR ENGLAND • LEAK PROOF SEALS • MCA (ASTON) LIMITED • GARDNER - WESTCOTT

WE ACCEPT VISA - MASTERCARD - DISCOVER - AMERICAN EXPRESS

PARTS SHIPPED WORLDWIDE !!!

VISA

MasterCard

Discover

**AMERICAN
EXPRESS**

VISIT OUR EBAY STORE

<http://stores.ebay.com/British-Only-Motorcycles-And-Parts>

TRIUMPH

MOTOR CYCLE REPLACEMENT PARTS

1946 MODELS

TIGER 85 : TIGER 100
3T DE LUXE AND SPEED-TWIN

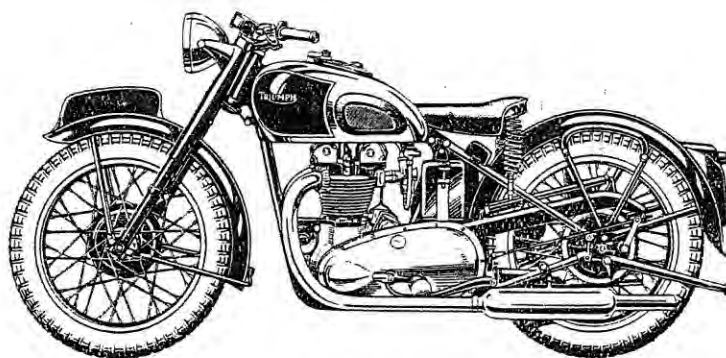

TRIUMPH ENGINEERING COMPANY LTD.
MERIDEN WORKS, ALLESLEY, COVENTRY

Codes
A.B.C. 5th Edition
Bentleys
and Marconi

Telephone
Coventry 60221 (7 Lines)
Telegrams (for Spares)
"Trusty," 60221 Coventry

PREFACE

BEFORE ordering parts for your machine, please read very carefully the instructions contained in the next paragraph. In a large number of cases, the information given in orders is not sufficient to enable us to identify customers' requirements with certainty. Delay is frequently occasioned by our having to refer the order back for further particulars before we can supply.

HOW TO ORDER. Every part is indicated by number, and this should be quoted together with the description. In order to assist customers, dimensions have been given in many cases where parts are similar. Parts where possible have been listed in order of assembly and a number of the illustrations show the assembly order also. With these aids, there should be no difficulty in identifying the parts you require. Always head your order with the engine number, stamped on the drive side of the crank case underneath the cylinder flange, together with the prefix letters. Use a separate sheet for your order if you are sending a letter as well.

SPECIMEN ORDER

12/2/46

**To the Triumph Engineering Co. Ltd.,
Meriden Works,
Allesley,
Coventry.**

Engine No. 46-5T-19463

Please supply :—

**1 - EI955 - Valve Inlet
1 - EI480 - Guide, inlet valve**

*** Send C.O.D.**

**Wm. Smith
1a, Ewell Avenue
Ewell, Surrey**

** For terms of business see page 3*

TELEGRAPHIC ORDERS. Orders by telegram should be addressed to "Trusty 60221 Coventry." They are then telephoned to us, which prevents delay in delivery. It is only necessary to quote part numbers in telegraphic orders, the description can be omitted.

PATTERNS AND PARTS FOR REPAIR. It is not necessary to send patterns if the part number is quoted. The sending of patterns often delays the order as parcel post or rail takes longer than letter post.

Parts sent to Coventry for repair, replacement or as patterns should bear the sender's name and address and clear instructions should accompany the parts. All parts must be forwarded carriage paid and care should be taken to ensure that all remittances are sent separately and not enclosed with the parts. Fragile units such as cylinders, etc., should always be boxed to avoid damage in transit. Complete machines should have all fittings such as horns, driving mirrors, tools, etc., removed by the sender before despatch, as it is impossible for us to accept responsibility in the event of loss in transit. We are always pleased to give estimates for overhauling and repairs, but should an estimate not be accepted, a charge will be made covering cost of dismantling and re-assembling, if carried out.

Accessories not of our manufacture should be sent direct to the actual makers, whose names appear on the goods in question. In the event of any doubt in this direction, we shall be pleased to supply the necessary information by return of post. All communications relating to spare parts, repairs, replacements and general service should be addressed to the Triumph Engineering Co. Ltd., Meriden Works, Allesley, Coventry, and in order to facilitate quick reference, the quoting of any order number, invoice number or reference from previous communications is of essential importance.

WHERE TO OBTAIN. Triumph Spare Parts may be obtained from any Triumph Dealer in Great Britain and Northern Ireland and we recommend our customers to place their orders with the Triumph Dealer in their district. When parts not usually asked for are required, and for which the Dealer may have to wire or obtain specially, the postage or carriage incurred becomes payable.

We are not able to supply Transfers as originally affixed to Triumph Motor Cycles, but we are at all times willing to supply a transfer denoting that the machine is of genuine Triumph manufacture, provided the Frame and Engine prefix letters and numbers are quoted.

Customers are warned against the risk incurred by purchasing parts that are not of genuine Triumph manufacture. This risk is eliminated if parts are ordered as instructed, either from our recognised Dealers, or direct from the Service Department, Meriden Works, Allesley, Coventry.

TERMS OF BUSINESS

THE most convenient method of paying for Spare Parts is by the C.O.D. system. By this method you pay the postman for the goods when he delivers them to you. As the minimum C.O.D. collection fee is 10d., only goods to the value of 2/- and over can be sent by this system. We do not despatch goods by rail C.O.D.

Where goods are not sent C.O.D., cash must accompany the order. All remittances should be made payable to the Triumph Engineering Co. Ltd., and crossed "Barclay's Bank Ltd." if in the form of Postal Order or cheque. Letters containing currency notes must be registered.

Should a remittance be forwarded by telegraphic money order, the name and address of the sender must be inserted in the space provided on the Post Office requisition form for a private message from remitter to payee. Unless this is complied with the Post Office omit such information from the telegram and we are not then in a position to trace the sender.

Postage, carriage and packing is charged at 5% on the value of the goods, minimum charge 6d. Packing boxes, cases, crates, etc., are charged for at cost and are returnable.

INDEX

	<i>Page</i>
BATTERY CARRIER GROUP	30
CARBURETTOR GROUP	53
CHAIN GROUP	42
CHAINGUARD GROUP	42
CONTROL CABLE GROUP	49
Clutch cable	49
Front brake cable	49
Throttle cable	49
ENGINE GROUP	7
Connecting rods	15
Crankcase	15
Crankcase bearing	16
Crankcase breather	17
Crankcase studs and bolts	16
Crankshaft and flywheel assembly	13
Cylinder block	7
Cylinder head	7
Engine sprocket and shock absorber	18
Oil pump	16
Overhead rocker	18
Piston	11
Push rods	17
Push rod cover tube	18
Release valve	16
Tappets	17
Timing cover	16
Timing gear	17
Valves	9
ENGINE PLATE GROUP	30
EXHAUST SYSTEM GROUP	19
Exhaust pipe	19
Silencer	19
FOOTREST GROUP	50
Footrest pillion	50
FRAME GROUP	26
Front portion	26
Rear portion	26
FRONT FORK GROUP	33
Front fork assembly	33
Steering cups, cones and balls	34
Steering damper	34
FRONT WHEEL GROUP	35
Front wheel brake	37
GASKET SETS	64
GEAR RATIOS	64
GEAR CONVERSION TABLES	64

	<i>Page</i>
GEARBOX GROUP	20
Clutch control	23
Gear control (enclosed footchange)	22
Gear control (selector mechanism)	22
Gearbox casing	20
Gearbox clutch	23
Gearbox fitting	20
Gearbox shell bearings	22
Gearbox sprocket	23
Kickstarter	23
Shafts and gears	20
HANDLEBAR GROUP	47
Clutch lever	47
Front brake control	47
Handlebar	47
Throttle control	47
LUCAS ELECTRICAL EQUIPMENT	61
Battery	62
Cable harness	62
Cut-out button	62
Cut-out and regulator unit	61
Dimmer switch	62
Dynamo	61
Headlamp	61
Horn	62
Instrument panel	62
Magneto	63
Tail lamp	62
MAGNETO (B.T.H.) GROUP	55
MUDGUARD GROUP	39
Front mudguard	39
Rear mudguard	39
NUMBER PLATE GROUP	41
Front number plate	41
Rear number plate	41
PILLION SEAT GROUP	51
PRIMARY CHAINCASE GROUP	41
REAR BRAKE CONTROL GROUP	49
REAR WHEEL GROUP	37
Rear wheel brake	39
SADDLE GROUP	50
SPARKING PLUG	52
SPEEDOMETER GROUP	52
STAND GROUP	35
Front stand	35
Rear stand	35
TANK GROUP	44
Oil tank	46
Petrol tank	44
TOOLBOX GROUP	51
TOOLKIT GROUP	51
WIDE RATIO GROUP	26

ILLUSTRATIONS

	<i>Page</i>
B.T.H. magneto armature and condenser	58
B.T.H. magneto contact breaker and housing	59
B.T.H. magneto housing and auto advance	57
Carburettor parts	54
Crankcase and frame studs, bolts and washers	31
Engine 3T and T85	
Crankcase, cylinder block and cylinder head, etc.	12
Engine 3T and T85	
Crankshaft, connecting rods, pistons, timing gears, etc.	14
Engine 5T and T100	
Crankcase, cylinder block and cylinder head, etc.	8
Engine 5T and T100	
Crankshaft, connecting rods, pistons, timing gears, etc.	10
Frame and components, 3T and T85	28
Frame and components, 5T and T85	27
Front and rear chaincases	43
Front wheel and mudguard arrangement	36
Gearbox casing and levers	21
Gears and clutch	24 & 25
Handlebars and controls	48
Petrol and oil tanks with fittings	45
Rear mudguard, number plate and toolbox	40
Rear wheel bearing assembly	38
Telescopic front forks	32

PART NUMBERS APPLY TO ALL MODELS EXCEPT WHERE OTHERWISE
STATED.

REPLACEMENT PARTS

PART NO.	DESCRIPTION	3T	T85	5T	T100
----------	-------------	----	-----	----	------

ENGINE GROUP

CYLINDER BLOCK

E2257	Block, cylinder	—	—	1	1
E1740	" " " " " " " " " "	1	1	—	—
E2249	Washer, cylinder base	—	—	1	1
E1775	" " " " " " " " " "	1	1	—	—

CYLINDER HEAD

E2258	Head, cylinder with guides	—	—	1	—
E2258A	" " " " " " " " " "	—	—	—	1
E2014	" " " " " " " " " "	1	1	—	—
E2248	Gasket, cylinder head	—	—	1	1
E1776	" " " " " " " " " "	2	2	—	—
E327	Bolt, " " " short	—	—	4	4
E1484	Bolt, " " " long (rear)	—	—	2	2
E1596	" " " " long (front)	—	—	2	2
E1795	" " " " long	4	4	—	—
E1796	" " " " short	4	4	—	—
S25-2	Washer, cylinder head bolt	8	8	4	4
E1675	Manifold, inlet	—	—	—	1
E1456	" " " " " " " " " "	—	—	1	—
E1552	" joint washer	—	—	2	—
E1676	" " " " " " " " " "	—	—	—	2
E1715	Stud, inlet manifold fixing	—	—	—	4
E1554	" " " " " " " " " "	—	—	4	—
E1720	Nut, inlet manifold stud	—	—	4	4
E1899	Flange, carburettor extension	1	1	—	—
E1553	Stud, carburettor fixing	—	—	2	2
E2424	" " and flange fixing	2	2	—	—
S1-51	Nut, carburettor stud	2	2	2	2
S25-3	Washer, " " " " " " " " " "	2	2	2	2
E1987	Stud, rocker cap inspection	2	2	—	—
E1912	Nut, " " stud	2	2	—	—

SEE SPECIMEN ORDER IN PREFACE.

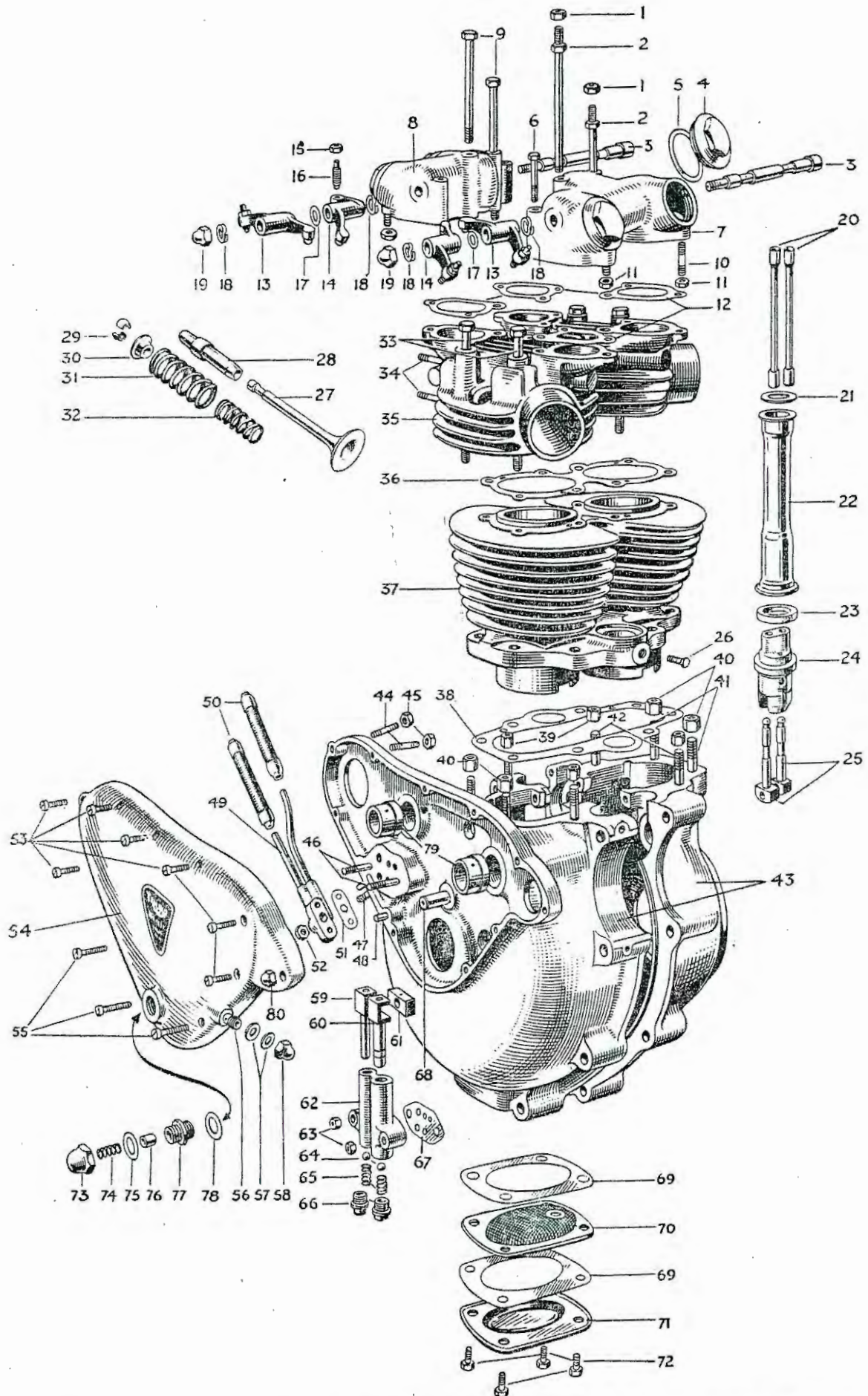

ENGINE 5T AND T100—CRANKCASE, CYLINDER BLOCK AND CYLINDER HEAD, ETC.

PART NO.	DESCRIPTION	3T	T85	5T	T100
VALVES					
E1955	Valve, inlet	—	—	2	2
E1751	" "	2	2	—	—
E1956	" exhaust	—	—	2	2
E1752	" "	2	2	—	—
E1480	Guide, inlet valve	—	—	2	2
E1604	" exhaust valve	—	—	2	2
E1759	" valve, inlet and exhaust	4	4	—	—
E1488	Spring, valve inner	—	—	4	4
E1777	" " "	4	4	—	—
E1487	" " outer	—	—	4	4
E1778	" " "	4	4	—	—
E1543	Collar, " spring (top)	—	—	4	4
E1757	" " " " "	4	4	—	—
E1544	Cup, " " (bottom)	—	—	4	4
E1758	" " " " "	4	4	—	—
WE259A	Cotter, valve split	8	8	8	8

INDEX TO ILLUSTRATION ON PAGE 8

1. SI-52	28. E1480	52. SI-51
2. E1596	E1604	53. E427
3. E1512	29. WE259A	54. E2218
4. E1564	30. E1543	55. E1049
5. E1577	31. E1487	56. E1586
6. E1545	32. E1488	57. E1335
7. E1462	33. E327	58. E1435
8. E1461	34. E1715 (T100)	59. E1475
9. E1484	E1554 (5T)	60. E1476
10. E1540	35. E2258 (5T)	61. E495
11. F879	E2258A (T100)	62. E1470
12. E1650	36. E2248	63. F879
13. E1458	37. E2257	64. S70-7
14. E1457	38. E2249	65. E403
15. E470	39. W76	66. E386
16. E1513	40. PO172A	67. E1537
17. E1575	41. E672	68. E375
18. E1574	42. E1614	69. E487
19. E1435	43. E2219/20	70. E529
20. E1693	44. E2022	71. E486
21. E1497	45. E2023	72. MT63
22. E2273	46. E1536	73. E2304
23. E1496	47. E1539	74. GS250
24. E1477	48. E1532	75. GS254
25. E1478	49. E1958	76. GS251
26. H200	49. E1526 (T100, 5T)	77. GS248
27. E1955	50. MF119	78. E1670
E1956	51. E1529	79. E1479
		80. E2228

DON'T FORGET TO SIGN YOUR ORDER.

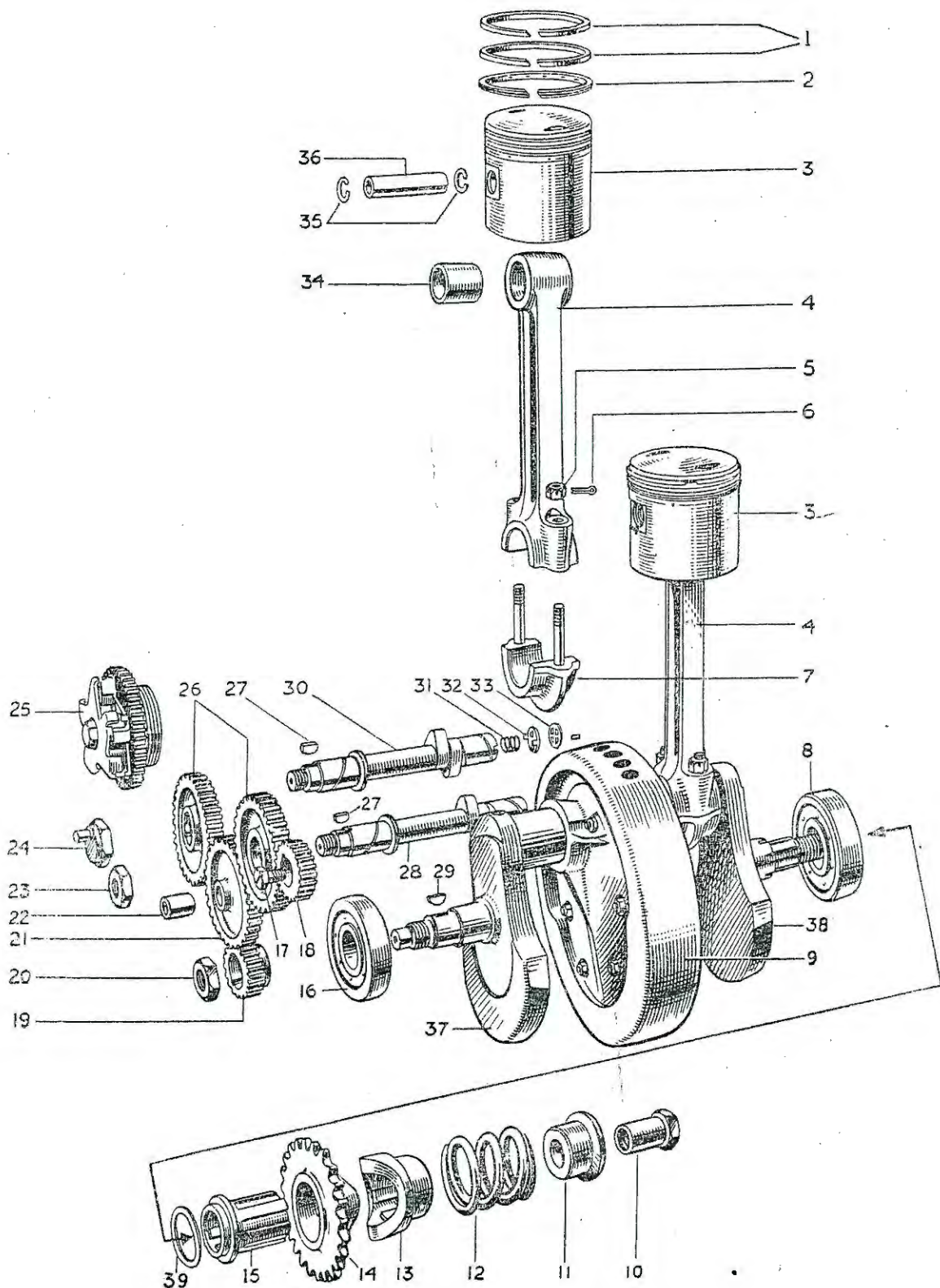

ENGINE 5T AND T100—CRANKSHAFT, CONNECTING RODS, PISTONS,
TIMING GEARS, ETC.

PART NO.	DESCRIPTION	3T	T85	5T	T100
PISTONS					
E1563	Piston assy., with rings, pin and circlip	—	—	2	—
E1563/5	" " " " " " " +.005"	—	—	2	—
E1563/10	" " " " " " " +.010"	—	—	2	—
E1563/20	" " " " " " " +.020"	—	—	2	—
E1908	" " " " " " " "	—	—	—	2
E1908/5	" " " " " " " +.005"	—	—	—	2
E1908/10	" " " " " " " +.010"	—	—	—	2
E1908/20	" " " " " " " +.020"	—	—	—	2
E1841	" " " " " " " "	—	2	—	—
E1841/5	" " " " " " " +.005"	—	2	—	—
E1841/10	" " " " " " " +.010"	—	2	—	—
E1841/20	" " " " " " " +.020"	—	2	—	—
E1748	" " " " " " " "	2	—	—	—
E1748/5	" " " " " " " +.005"	2	—	—	—
E1748/10	" " " " " " " +.010"	2	—	—	—
E1748/20	" " " " " " " +.020"	2	—	—	—
E656	Ring, piston compression	—	—	4	4
E656/5	" " " " +.005"	—	—	4	4
E656/10	" " " " +.010"	—	—	4	4
E656/20	" " " " +.020"	—	—	4	4
E1766	" " " " "	4	4	—	—
E1766/5	" " " " +.005"	4	4	—	—
E1766/10	" " " " +.010"	4	4	—	—
E1766/20	" " " " +.020"	4	4	—	—
GE29	" " scraper	—	—	2	2
GE29/5	" " " +.005"	—	—	2	2
GE29/10	" " " +.010"	—	—	2	2
GE29/20	" " " +.020"	—	—	2	2
E1819	" " " "	2	2	—	—
E1819/5	" " " +.005"	2	2	—	—
E1819/10	" " " +.010"	2	2	—	—
E1819/20	" " " +.020"	2	2	—	—
WE203E	Pin, gudgeon	—	—	2	2
E1750	" " " "	2	2	—	—
E1767	Circlip, gudgeon pin retaining	4	4	—	—
WE479	" " " "	—	—	4	4

INDEX TO ILLUSTRATION ON PAGE 10

1. E656	14. E1680C	26. E1486
2. GE29	E1680F (sidecar)	27. E1558
3. E1563 (5T)	15. E1521	28. E1485
E1908 (T100)	16. E1592	29. E1580
4. E1489	17. 111,700	30. E2302
5. E1530	18. E2229	31. E2256
6. 1/16" × 3/4" split pin	19. E1472	32. E2254
7. Sold with E1489 only	20. E398	33. GS87
8. E1591	21. E1471	34. E1511
9. E1510A	22. E400	35. WE479
10. E509	23. E1492	36. WE203E
11. E396	24. E1463	37. E1459
12. E395	25. E1992	38. E1460
13. E1681		

SEE PAGE 64 FOR GASKET SETS

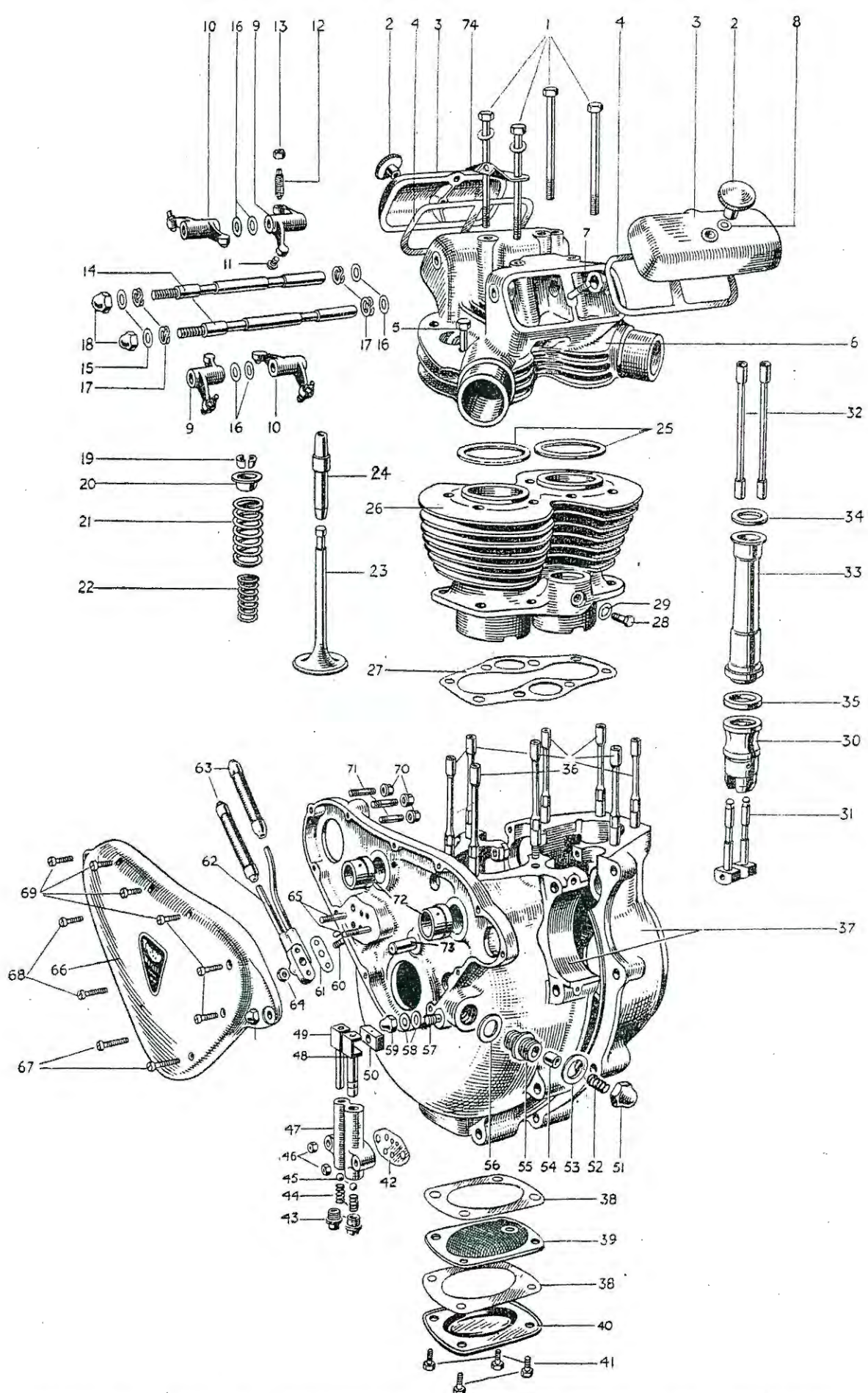

ENGINE 3T AND T85—CRANKCASE, CYLINDER BLOCK AND CYLINDER HEAD, ETC.

CRANKSHAFT AND FLYWHEEL ASSY.

E1460A	Crankshaft and flywheel assy. ...	—	—	1	1
E2200A	" " " " c/w connecting rods...	1	1	—	—
E1510A	Flywheel ...	—	—	1	1
E1745	" ...	1	1	—	—
E1459	Crankshaft, timing side ...	—	—	1	1
E1747	" " " ...	1	1	—	—
E1460	" driving side ...	—	—	1	1
E2200	" " " ...	1	1	—	—
E1790	Tube, crankshaft ...	1	1	—	—
E393	Plug, crankshaft ...	—	—	1	1
E1562	Bolt, crankshaft to flywheel ...	—	—	6	6
E1760	" " " " ...	2	2	—	—
W103	Nut, crankshaft to flywheel bolt ...	—	—	6	6
E1797	" " " " " ...	2	2	—	—

INDEX TO ILLUSTRATION ON PAGE 12

1. E1795	25. E1776	50. E495
2. E1912	26. E1740	51. E2304
3. E1779	27. E1775	52. GS250
4. E1780	28. H200	53. GS254
5. E1796	29. E2312	54. GS251
6. E2014	30. E1837	55. GS248
7. E1987	31. E1478	56. E1670
8. PT1048	32. E1785	57. E1586
9. E1755	33. E1838	58. E1335
10. E1756	34. E1497	59. E1435
11. E1483	35. E2425	60. E1539
12. E1513	36. E1791	61. E1529
13. E470	37. E2250/51	62. E1526
14. E1813	38. E487	63. MF119
15. E1330	39. E529	64. SI-51
16. E1575	40. E486	65. E1536
17. E1574	41. MT63	66. E2252
18. E1435	42. E1537	67. E1049
19. WE259A	43. E386	68. E427
20. E1757	44. E403	69. E452
21. E1778	45. S70-7	70. E2023
22. E1777	46. F879	71. E2022
23. E1751 IN	47. E1470	72. E1479
E1752 EX	48. E1476	73. E375
24. E1759	49. E1475	74. F2380

DON'T FORGET TO SIGN YOUR ORDER

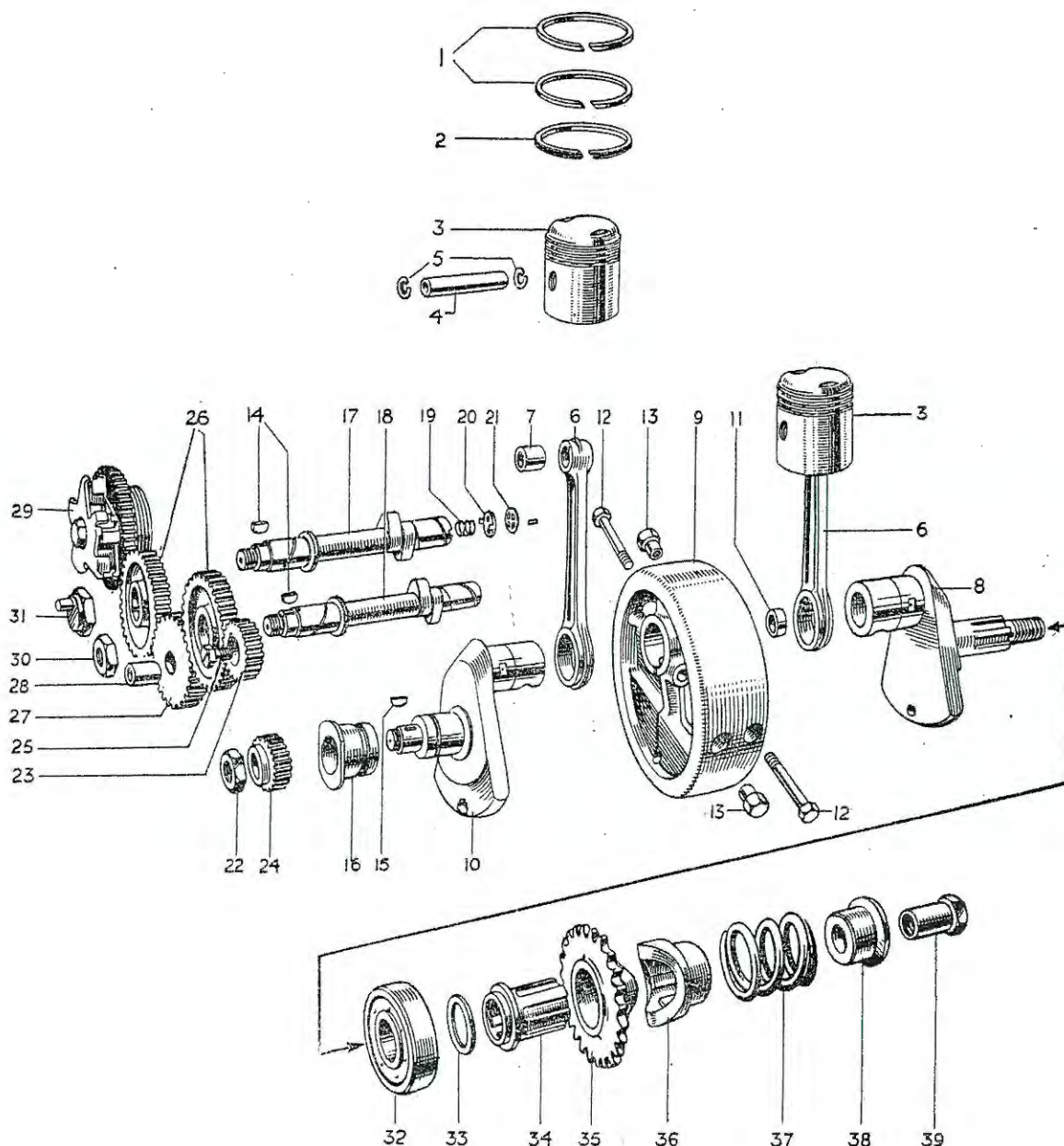

1. E1766	14. E1558	28. E400
2. E1819	15. E1580	29. E1992
3. E1748 (3T) E1841 (T85)	16. E1769	30. E1463
4. E1750	17. E2266	31. E1492
5. E1767	18. E1754	32. E1592
6. E1749	19. E2256	33. E1732
7. E1762	20. E2254	34. E1521
8. E2200	21. GS87	35. E1680F
9. E1745	22. E398	36. E1681
10. E1747	23. E2229	37. E659
11. E1790	24. E1771	38. E396
12. E1760	25. 111,700	39. E509
13. E1797	26. E1486	
	27. E2202	

ENGINE 3T AND T85—CRANKSHAFT, CONNECTING RODS, PISTONS, TIMING GEARS, ETC.

PART NO.	DESCRIPTION	3T	T85	5T	T100
CRANKCASE					
E2219/20	Crankcase assy., less main bearings ...	—	—	1	1
E2250/51	" " " " " " ...	1	1	—	—
E672	Stud, crankcase cylinder base ...	—	—	4	4
E1614	" " " " dowel ...	—	—	4	4
E1791	" " " " " " ...	8	8	—	—
W76	Nut, crankcase cylinder base stud ...	—	—	4	4
PO172A	" " " " " " ...	—	—	4	4
E1534A	Dowel, cylinder base (hollow for stud E1614) ...	—	—	2	2
E1579	Dowel, crankcase halves (hollow) ...	1	1	1	1
E2022	Stud, magneto fixing ...	3	3	3	3
E2023	Nut, " " " " " " ...	3	3	3	3
E1539	Stud, oil junction block ...	1	1	1	1
E1532	Dowel, " " " " (hollow) ...	1	1	1	1
E1535	Dowel, crankcase to timing cover (hollow) ...	—	—	1	1
E1508	Pipe, crankcase oil return ...	—	—	1	1
E1770	" " " " " " ...	1	1	—	—
E1509	Clip, crankcase oil return pipe ...	1	1	1	1
E1645	Screw, crankcase oil return pipe clip ...	1	1	1	1
E1536	Stud, oil pump ...	2	2	2	2
F879	Nut, oil pump stud ...	2	2	2	2
E2312	Washer, oil pump stud ...	2	2	2	2
E529	Filter, crankcase oil ...	1	1	1	1
E486	Cover, crankcase oil filter ...	1	1	1	1
E487	Washer, crankcase oil filter joint ...	2	2	2	2
MT63	Screw, " " " " " " ...	4	4	4	4
S26-2	Washer spring, " " " " " " ...	4	4	4	4
E1586	Stud, oil gauge connection ...	1	1	—	—
E1435	Nut, " " " " " stud ...	1	1	—	—
E1335	Washer, " " " " " " ...	1	1	—	—
E2311	Pin, breather locating ...	1	1	1	1

CONNECTING RODS

E1489	Rod, connecting complete ...	—	—	2	2
E1749	" " " " " " ...	2	2	—	—
E1511	Bush, conn rod small end ...	—	—	2	2
E1762	" " " " " " ...	2	2	—	—
E1530	Nut, conn rod end cap stud ...	—	—	4	4
E1719	Washer, " " " " " nut ...	—	—	4	4
	Pin, split for E1530 nut 1/16" ...	—	—	4	4
The following parts are employed with detachable big end bearing bolts:					
E2448	Bolt, conn rod end cap ...	—	—	4	4
E1530	Nut, " " " " " bolt ...	—	—	4	4
E1719	Washer, " " " " " " ...	—	—	4	4

ENGINE NUMBER IS IMPRESSED ON DRIVING SIDE OF CRANKCASE.

PART NO.	DESCRIPTION	3T	T85	5T	T100
CRANKCASE BEARINGS					
E1592	Bearing, c/c timing side	—	—	1	1
E1769	" " " " (plain)	1	1	—	—
E1592	" " driving side	1	1	—	—
E1591	" " " "	—	—	1	1
E2296	Disc, timing side bearing	—	—	1	1
E489	Ring, retaining t/s bearing	—	—	1	1
E1479	Bush, camshaft timing side	2	2	2	2
E1516	" " drive "	1	1	1	1
E2260	" " " " (breather)	1	1	1	1
CRANKCASE STUDS AND BOLTS					
E1555	Screw, crankcase top rear	1	1	1	1
S25-3	Washer, " " " screw	1	1	1	1
E925	Stud, crankcase bottom front	1	1	—	—
T456	" " " "	—	—	1	1
S1-51	Nut, " " " stud	2	2	2	2
S25-3	Washer, " " " "	2	2	2	2
E1647	Screw, " " inside boss	2	2	2	2
FOR ENGINE PLATE STUDS SEE PAGE 30					
OIL PUMP					
E2140	Pump, oil—complete	1	1	1	1
E1470	Body, oil pump	1	1	1	1
E1475	Plunger, oil pump feed	1	1	1	1
E1476	" " " " scavenge	1	1	1	1
E495	Slider block, oil pump driving	1	1	1	1
E403	Spring, oil pump valve	2	2	2	2
S70-7	Ball, " " " "	2	2	2	2
E386	Plug, " " " "	2	2	2	2
E1537	Washer, oil pump joint.	1	1	1	1
RELEASE VALVE					
GS253	Oil release valve complete	1	1	1	1
GS248	Body, oil release valve	1	1	1	1
GS251	Piston, " " " "	1	1	1	1
GS250	Spring, " " " "	1	1	1	1
E1670	Washer, oil release valve body	1	1	1	1
E2304	Cap, " " " "	1	1	1	1
GS254	Washer, " " " " cap	1	1	1	1
TIMING COVER					
E2252	Cover, timing gear	1	1	—	—
E2218	" " " "	—	—	1	1
E378	Bush, timing gear cover to c/s	—	—	1	1
E1586	Stud, oil gauge connection	—	—	1	1
E1435	Nut, " " " stud	—	—	1	1
E1335	Washer, oil gauge connection stud	—	—	2	2

FIGURE IN MODEL COLUMN DENOTES QUANTITY PER MACHINE.

PART NO.	DESCRIPTION	3T	T85	5T	T100
E1595	Patent plate	—	—	1	—
E1678	" "	—	—	—	1
E2306	" "	—	1	—	—
E1891	" "	1	—	—	—
D208-5	Screw, hammer drive	3	3	3	3
E1049	Screw, timing gear cover, long	2	2	3	3
E452	" " " " short	6	6	—	—
E427	" " " " medium	2	2	7	7

TIMING GEAR

E1771	Pinion, timing	1	1	—	—
E1472	" "	—	—	1	1
E1580	Key, timing pinion	1	1	1	1
E398	Nut, " "	1	1	1	1
E2266	Camshaft, inlet	1	1	—	—
E2302	" "	—	—	1	1
E1754	" exhaust	1	1	—	—
E1485	" "	—	—	1	1
E1486	Wheel, camshaft inlet or exhaust	2	2	2	2
E1558	Key, camshaft wheel	2	2	2	2
E1492	Nut, " " exhaust	1	1	1	1
E1463	" " " " inlet	1	1	1	1
E2202	Wheel intermediate	1	1	—	—
E1471	" "	—	—	1	1
E400	Bush, intermediate wheel	1	1	1	1
E375	Spindle, " "	1	1	1	1
E1992	Gear, magneto c/w auto advance (B.T.H.)	1	1	1	1
498152	" " " " " (Lucas)	1	1	1	1
E2229	Pinion, dynamo	1	1	1	1

CRANKCASE BREATHER

E2254	Valve, rotary	1	1	1	1
GS87	Disc, valve	1	1	1	1
E2256	Spring, valve	1	1	1	1
E2264	Pipe, breather	1	1	1	1
E2265	Nut, breather pipe	1	1	1	1

TAPPETS

E1478	Tappet, valve	4	4	4	4
E1477	Block, valve tappet	—	—	2	2
E1837	" " " "	2	2	—	—
H200	Lock screw, valve tappet block	2	2	2	2
E2312	Washer, " " " "	2	2	2	2

PUSH ROD

E1785	Rod, valve push	4	4	—	—
E1693	" " " "	—	—	4	4

LETTERS FORMING PART OF ENGINE NUMBER ARE IMPORTANT.

PART NO.	DESCRIPTION	3T	T85	5T	T100
PUSH ROD COVER TUBE					
E1838	Tube, push rod cover	2	2	—	—
E2273	" " " "	—	—	2	2
E1496	Washer, push rod seal (lower)	—	—	2	2
E2425	" " " " " "	2	2	—	—
E1497	" " " " (upper)	2	2	2	2
OVERHEAD ROCKERS					
E1461	Box, rocker inlet	—	—	1	1
E1462	" " exhaust	—	—	1	1
E1650	Gasket, rocker box	—	—	4	4
E1540	Stud, " "	—	—	4	4
F879	Nut, " " stud	—	—	4	4
E1564	Cap, " " inspection	—	—	4	4
E1779	" " " " " "	2	2	—	—
E1577	Washer, " " " cap	—	—	4	4
E1780	" " " " " "	2	2	—	—
E1912	Nut, " " " " " "	2	2	—	—
PT104B	" " " " " (fibre)	2	2	—	—
E1545	Screw, " " " "	—	—	4	4
S25-13	Washer, " " screw	—	—	4	4
E1755	Rocker, valve, R.H.	2	2	—	—
E1457	" " " " " "	—	—	2	2
E1756	" " L.H.	2	2	—	—
E1458	" " " " " "	—	—	2	2
E1483	Pin, valve rocker ball	4	4	4	4
E1513	" " " adjusting	4	4	4	4
E470	Nut, " " " pin	4	4	4	4
E1330	Washer, valve rocker thrust, $\frac{3}{8}$ "	2	2	2	2
E1575	" " " " " $\frac{1}{2}$ "	6	6	6	6
E1574	" " " thackeray	4	4	4	4
E1813	Spindle, " " " "	2	2	—	—
E1512	" " " " " "	—	—	2	2
E1435	Nut, " " spindle	2	2	2	2
E1335	Washer, " " " "	4	4	4	4
E1781	Pipe, " " lubricating	1	1	—	—
E1937	" " " " " "	—	—	1	1
E1947	Tube, pipe connecting rubber	1	1	1	1
E1948	Pipe, oil gauge	1	1	1	1
XA69	Clip, pipe	5	5	5	5
ENGINE SPROCKET AND SHOCK ABSORBER					
E1680F	Sprocket, engine 19T	1	1	—	—
E1680F	" " 19T (sidecar)	—	—	1	1
E1680C	" " 22T	—	—	1	1

SEE SPECIMEN ORDER IN PREFACE.

PART NO.	DESCRIPTION	3T	T85	5T	T100
E1680G	Sprocket, engine 18T		As required		
E1680E	" " 20T		"	"	
E1680D	" " 21T		"	"	
E1681	Slider, shock absorber	1	1	1	1
E1521	Sleeve, " "	1	1	1	1
E659	Spring, " "	1	1	—	—
E395	" " " "	—	—	1	1
E396	Collar, " "	1	1	1	1
E509	Nut, " " sleeve	1	1	1	1
E1732	Washer, engine sprocket distance	1	1	—	—

EXHAUST SYSTEM GROUP

EXHAUST PIPE

E2236A	Pipe, exhaust, N.S.	1	1	—	—
E1520	" " " "	—	—	1	1
E2237A	" " O.S.	1	1	—	—
E1519	" " " "	—	—	1	1
E2269	Clip, exhaust pipe to cylinder	2	2	—	—
E1269	" " " " " clip	—	—	2	2
E409	Bolt, " " " " clip	2	2	2	2
E410A	Washer, " " clip bolt	2	2	2	2

SILENCER

E2238	Silencer, N.S.	1	1	—	—
E2276	" " " "	—	—	1	1
E2239	" O.S.	1	1	—	—
E2286	" " " "	—	—	1	1
E667A	Bolt, silencer hanger	2	2	—	—
E688	" " " "	—	—	2	2
T224	Nut, " " bolt	2	2	2	2
E2271	Clip, silencer to exhaust pipe	2	2	—	—
E1692	" " " " " "	—	—	2	2
TE164E	Bolt, " " " " clip	2	2	2	2
TE164C	"D" nut " " " " bolt	2	2	2	2
TE164D	"D" washer " " " " " "	2	2	2	2

PRICES DO NOT INCLUDE POSTAGE OR CARRIAGE.

PART NO.	DESCRIPTION	3T	T85	5T	T100
----------	-------------	----	-----	----	------

GEARBOX GROUP

GEARBOX CASING

T264A	Casing with bushes, gearbox	1	1	1	1
E698	Stud, gearbox casing outer cover	2	2	2	2
S1-51	Nut, " " " stud	2	2	2	2
S25-3	Washer, " " " "	2	2	2	2
T411	Cover, with bushes, gearbox outer	1	1	1	1
T452	Screw, outer cover to case	1	1	1	1
E573	" " " " " "	1	1	1	1
E427	" " " " inner cover	3	3	3	3
T410	Cover, with bushes gearbox inner	3	3	3	3
T323A	Stud, gearbox inner cover to outer cover	1	1	1	1
S1-51	Nut, inner cover to outer cover stud	1	1	1	1
S25-3	Washer, " " " " " "	1	1	1	1
E329	Screw, gearbox inner cover to case	1	1	1	1
E427	Screw, inner cover to case	2	2	2	2
T45	Stop, kickstarter quadrant	1	1	1	1
T400	Cap, gearbox filler	1	1	1	1
NT376	Washer, gearbox filler cap	1	1	1	1
S46-15	Plug, gearbox drain and inner cover level	2	2	2	2
PT104B	Washer, gearbox drain and inner cover level	2	2	2	2

GEARBOX FITTINGS

T717	Plate, gearbox mounting clamp	2	2	2	2
T456	Stud, gearbox clamp tie	2	2	2	2
S1-51	Nut, " " stud	3	3	3	3
T461	Nut, " " " "	1	1	1	1
F1681	Bolt, gearbox clamp pin	1	1	1	1
S4-13	Nut, " " " bolt	1	1	1	1
S25-8	Washer, " " " " "	1	1	1	1
S26-3	" " " " " spring	2	2	2	2
T430	Bolt, gearbox pivot	—	—	1	1
F2391	" " " " " "	1	1	—	—
F1126	Nut, " " " bolt	1	1	1	1
S26-1	Washer, " " " " "	1	1	1	1
T275	Adjuster assy., primary chain	1	1	1	1

SHAFTS AND GEARS

T441	Mainshaft	1	1	1	1
S66-1	Woodruff key, No. 6	1	1	1	1
T421	Nut, clutch to mainshaft	1	1	1	1
T420	Plain washer, clutch to mainshaft	1	1	1	1
T524	Lock washer, " " "	1	1	1	1
T433	Layshaft	1	1	1	1
T432	Tube, layshaft distance	1	1	1	1
T726	Gear, mainshaft high	1	1	1	1
T492	Tube, mainshaft high gear distance	1	1	1	1

ALL GOODS SENT TO WORKS MUST BE CARRIAGE PAID.

GEARBOX CASING AND LEVERS.

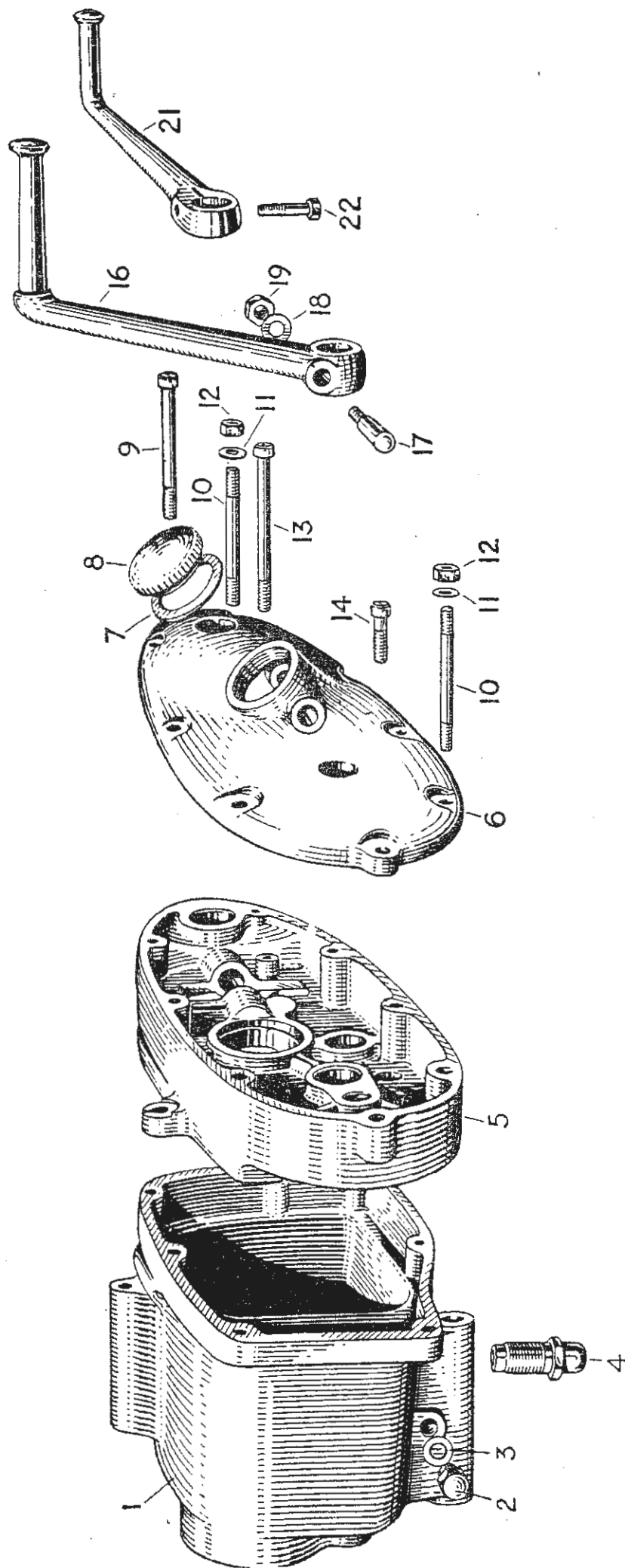

- 1. T264A
- 2. S46-15
- 3. PT104B
- 4. T372
- 5. T410

- 6. T411
- 7. NT376
- 8. T400
- 9. E573
- 10. E698

- 11. S25-3
- 12. S1-51
- 13. T452
- 14. E427
- 16. T451

- 17, 18, 19. S52-1
- 21. T398
- 22. T450

PART NO.	DESCRIPTION	3T	T85	5T	T100
T446	Bush, gearbox mainshaft high gear	2	2	2	2
T443	Gear, mainshaft 3rd (23T)	1	1	1	1
T727	Gear, mainshaft 2nd	1	1	1	1
T434	Gear, layshaft high	1	1	1	1
T438	Bush, layshaft high gear	2	2	2	2
T435	Gear, layshaft 3rd	1	1	1	1
T436	Gear, layshaft 2nd	1	1	1	1
T437	Gear, layshaft low	1	1	1	1
T431	Bush, layshaft low gear	1	1	1	1

On machines previous to engine No. 74760 use :—

T444 for T726 Gear mainshaft high

T442 for T727 " " 2nd

GEARBOX SHELL BEARINGS

T448	Bearing, high gear	1	1	1	1
T445	Cover, high gear bearing dust	1	1	1	1
E489	Ring, " " " retaining	1	1	1	1
S35-7	Bearing, mainshaft	1	1	1	1
T280	Ring, bearing retaining	1	1	1	1
T290	Bush, layshaft	2	2	2	2
T18	Disc, layshaft bush	1	1	1	1
T341	Bush, gear selector cam plate	1	1	1	1
T412	Bush, footchange spindle (inner)	1	1	1	1
T57	" " " (outer)	1	1	1	1
T362	Bush, kickstarter (inner)	1	1	1	1
T23	" " (outer)	1	1	1	1

GEAR CONTROL (SELECTOR MECHANISM)

T397	Quadrant, gear operating	1	1	1	1
T399	Spindle, gear operating quadrant	1	1	1	1
	Split pin, $1\frac{1}{2} \times 5/64$	1	1	1	1
T500	Camplate, gear control	1	1	1	1
NT261	Roller, gear control cam plate	2	2	2	2
T501	Plunger, " " " "	1	1	1	1
T372	Bush, " " " "	1	1	1	1
T373	Spring, " " " "	1	1	1	1
T260	Fork, gear selector mainshaft	1	1	1	1
T261	" " " layshaft	1	1	1	1
T291	Rod, " " fork	1	1	1	1

GEAR CONTROL (ENCLOSED FOOTCHANGE)

T407	Plate, footchange guide	1	1	1	1
T454	Stud, " " plate	4	4	4	4
F879	Nut, " " " stud	4	4	4	4
E2312	Washer, " " " " (shakeproof)	4	4	4	4
T408/9	Plunger assy. gear quadrant	1	1	1	1
T406	Plunger, gear quadrant	2	2	2	2
T405	Spring, " " plunger	2	2	2	2
T398	Pedal, footchange	1	1	1	1
T450	Set screw, footchange pedal	1	1	1	1
T404	Spring, footchange pedal return	2	2	2	2
T395	Finger, gear indicator	1	1	1	1

TREASURY NOTES MUST BE REGISTERED.

PART NO.	DESCRIPTION	3T	T85	5T	T100
T224	Nut, gear indicator ...	1	1	1	1
S25-3	Washer, " " ...	1	1	1	1
T396	Quadrant, " " ...	1	1	1	1
D208-17	Pin, gear indicator ququadrant fixing ...	2	2	2	2
KICKSTARTER					
T451	Crank, kickstarter ...	1	1	1	1
F1814	Rubber, " crank ...	1	1	1	1
S52-1	Cotter pin, complete with nut and washer ...	1	1	1	1
T31	Spring, " return ...	1	1	1	1
T47	Peg, " " spring anchor ...	1	1	1	1
T25A	Quadrant, kickstarter ...	1	1	1	1
T24A	Shaft, kickstarter axle ...	1	1	1	1
T730	Pinion, " ...	1	1	1	1
T731	Ratchet, " ...	1	1	1	1
T488/28	Sleeve and spring, pinion ...	1	1	1	1
NT297	Nut, kickstarter ratchet ...	1	1	1	1
T732	Washer, " " lock ...	1	1	1	1
T505	Washer, " " ...	1	1	1	1
GEARBOX SPROCKET					
T471	Sprocket, gear box 18T ...	1	1	1	1
T440	Nut, gearbox sprocket locking ...	1	1	1	1
GEARBOX CLUTCH					
T416/428	Housing, with sprocket, clutch ...	—	—	1	1
T416A/428	" " " " ...	1	1	—	—
T394	Rollers ...	20	20	20	20
T417	Centre, clutch ...	—	—	1	1
T417A	" " " " ...	1	1	—	—
T414	Plate, clutch driving corked ...	3	3	4	4
NT288	Insert, clutch cork ...	72	72	96	96
T415	Plate, clutch driven ...	4	4	5	5
T429	Spring, clutch ...	4	4	4	4
T424	Pin, clutch spring ...	4	4	—	—
T423	" " " " ...	—	—	4	4
T427	Nut, " " pin ...	4	4	4	4
T425	Cup, clutch spring ...	4	4	4	4
T419	Plate assy., clutch pressure ...	1	1	1	1
T422	Button, clutch pressure plate ...	1	1	1	1
T418	Hub, clutch ...	1	1	1	1
CLUTCH CONTROL					
T487	Lever, clutch operating ...	1	1	1	1
T495	Cap, " " lever, rubber ...	1	1	1	1
T402	Arm, " " " " ...	1	1	1	1
T401	Peg, " " " " ...	1	1	1	1
E2312	Washer, " " " peg (shakeproof) ...	1	1	1	1
T413	Pin, clutch lever adjusting with ball ...	1	1	1	1
T453	Nut, " " " pin locking ...	1	1	1	1
T455	Rod, " " operating ...	—	—	1	1
T455A	" " " " " " ...	1	1	—	—
PT108B	Bush, mainshaft clutch rod ...	1	1	1	1

CLUTCH PLATES CAN BE PROMPTLY RECORKED.

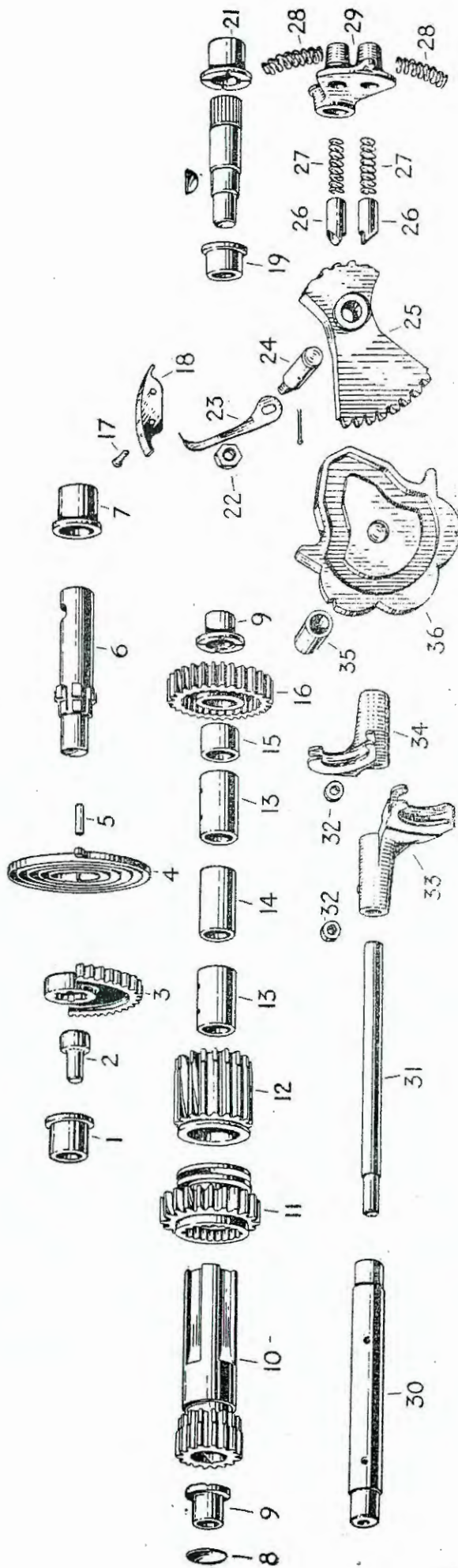

1. T362	16. T437	32. NT261	47. T501	63. T429	76, 77, 78, 79. T416/428
2. T45	17. D208-17	33. T261	48. T373	64. T425	(500 c.c.)
3. T25A	18. T396	34. T260	49. S35-7	65. T419	T416A/428
4. T31	19. T412	35. T341	50. T280	66. T422	(350 c.c.)
5. T47	21. T57	36. T500	51. T505	67. T415	
6. T24A	22. T224	37. T440	52, 53. T488/28	68. NT288	80. T394
7. T23	23. T395	38. T471	54. T730	69. T414	81. T418
8. T18	24. T399	39. E489	55. T731	70. T455 (350 c.c.)	82. S66-1
9. T290	25. T397	40. T445	56. T732	71. T421	83. T413
10. T434	26. T406	41. T448	57. NT297	72. T420	84. T401
11. T436	27. T405	42. T446	58. T407	73. T524	85. T402
12. T435	28. T404	43. T726	59. T454	74. T417 (500 c.c.)	86. T453
13. T438	29. T408/9	44. T443	60. E2312	75. T424	87. T487
14. T432	30. T433	45. T727	61. F879		88. PT108B
15. T431	31. T291	46. T441	62. T427		

GEARS AND CLUTCH.

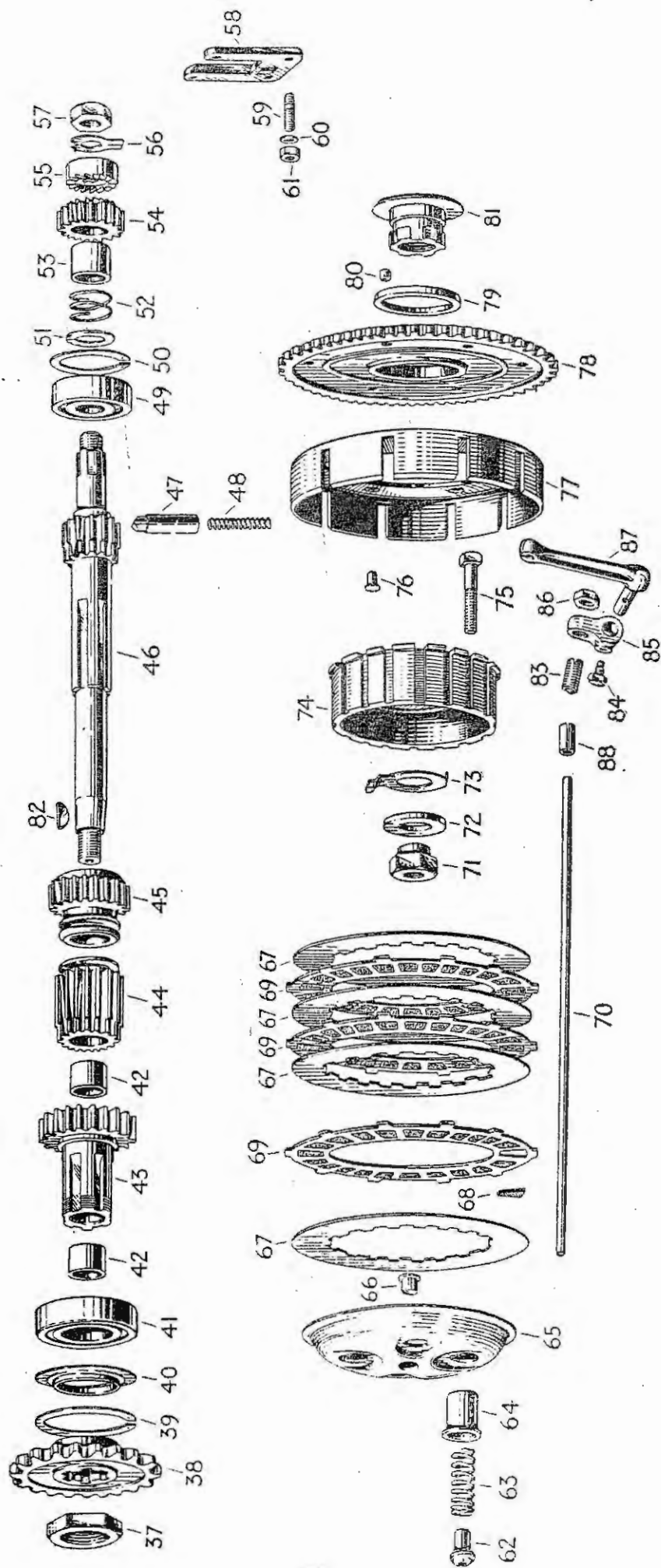

PART NO.	DESCRIPTION	3T	T85	5T	T100
----------	-------------	----	-----	----	------

WIDE RATIO GEAR GROUP

T465	High gear, mainshaft	1	1	1	1
T466	" " layshaft	1	1	1	1
T467	2nd " mainshaft	1	1	1	1
T468	2nd " layshaft	1	1	1	1

FRAME GROUP

FRONT PORTION

F2385	Frame, front portion	1	1	—	—
F2400	" " "	—	—	1	1
E1023	Stud, seat lug to back stays	1	1	—	—
F1561	" " " " " " "	—	—	1	1
PO172A	Nut, " " " " " stud	2	2	2	2
S26-1	Washer, " " " " " "	2	2	2	2
F994	Stud, frame to chain stay seat tube	1	1	1	1
SI-30	Nut, " " " " " " stud	2	2	2	2
SCZ45	Washer, " " " " " " "	2	2	2	2
F2380	Bracket, engine to frame torque	1	1	—	—
E1597	Stay, " " " " " "	—	—	2	2
F2381	Clip, " " " " " bracket	1	1	—	—
E1598	" " " " " stay	—	—	1	1
DS55	Bolt, " " " " " bracket clip	1	1	—	—
F1031	" " " " " " " stay	—	—	1	1
SI-51	Nut, " " " " " " "	1	1	—	—
PO172A	" " " " " " " "	—	—	1	1
S25-3	Washer, " " " " " " "	1	1	1	1
SI-52	Nut, cyl. head bolt torque stay fixing	—	—	2	2
S26-1	Washer, " " " " " " "	—	—	2	2
F1841	Support, petrol tank front	—	—	1	1
F1451	Bolt, tank front support	—	—	1	1
SI-52	Nut, " " " " bolt	—	—	1	1
F1671	Support, petrol tank rear	—	—	1	1
F1213	Bolt, tank rear support	—	—	2	2
S26-3	Washer, " " " " bolt	—	—	2	2
NW100	Lubricator, steering column	1	1	1	1

SEE FRONT FORK GROUP FOR HEAD LUG STEERING RACES.

REAR PORTION

F2385A	Frame, rear portion	1	1	—	—
F1616A	" " " " " " "	—	—	1	1
F969	Screw, rear chain adjuster	2	2	2	2
F1008	Locknut, " " " " screw	2	2	—	—
F1824	" " " " " " "	—	—	2	2

FRAME NUMBER IS ON FRONT TOP OF HEAD LUG.

FRAME AND COMPONENTS 5T AND T100.

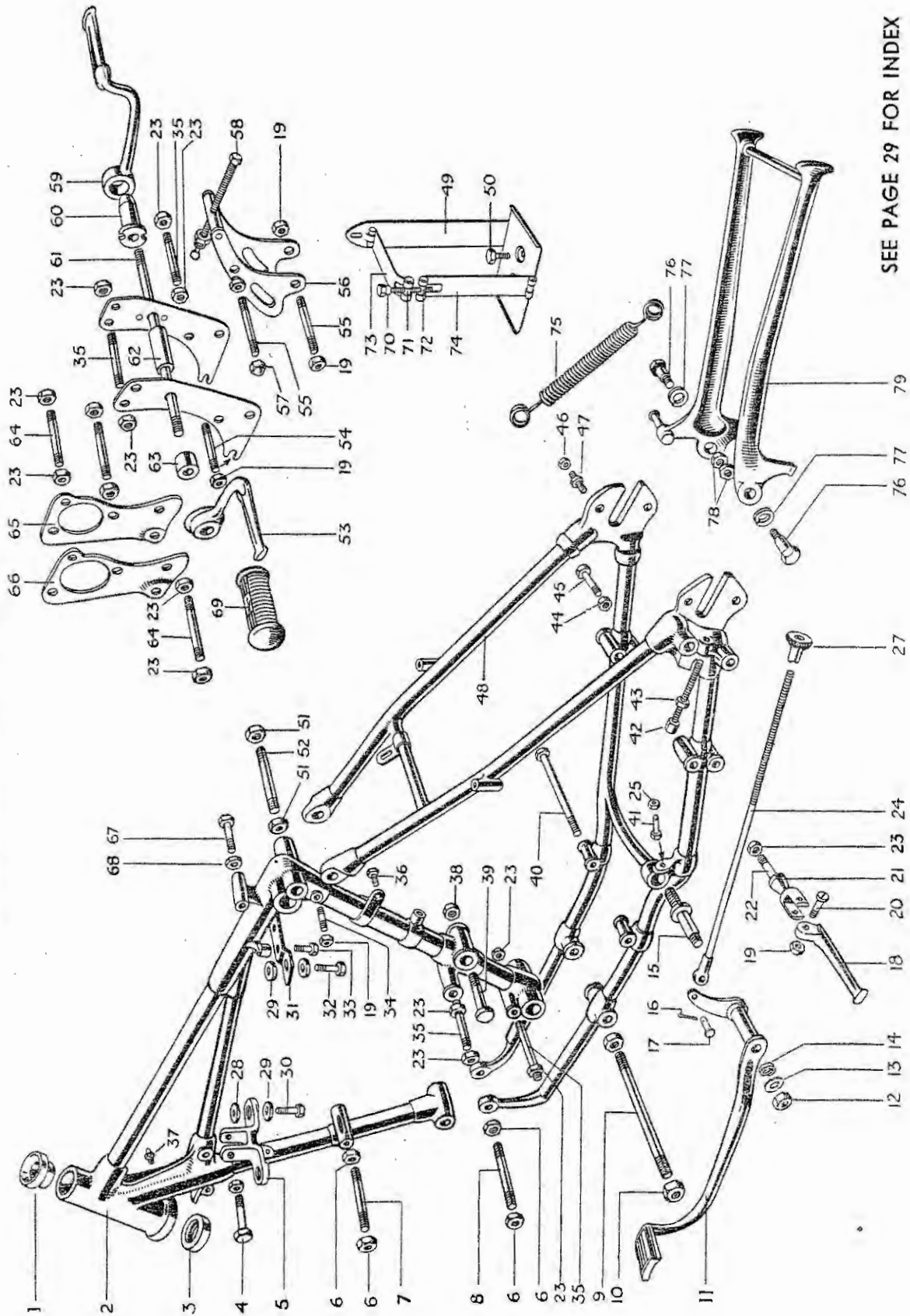

SEE PAGE 29 FOR INDEX

FRAME AND COMPONENTS 3T AND T85.

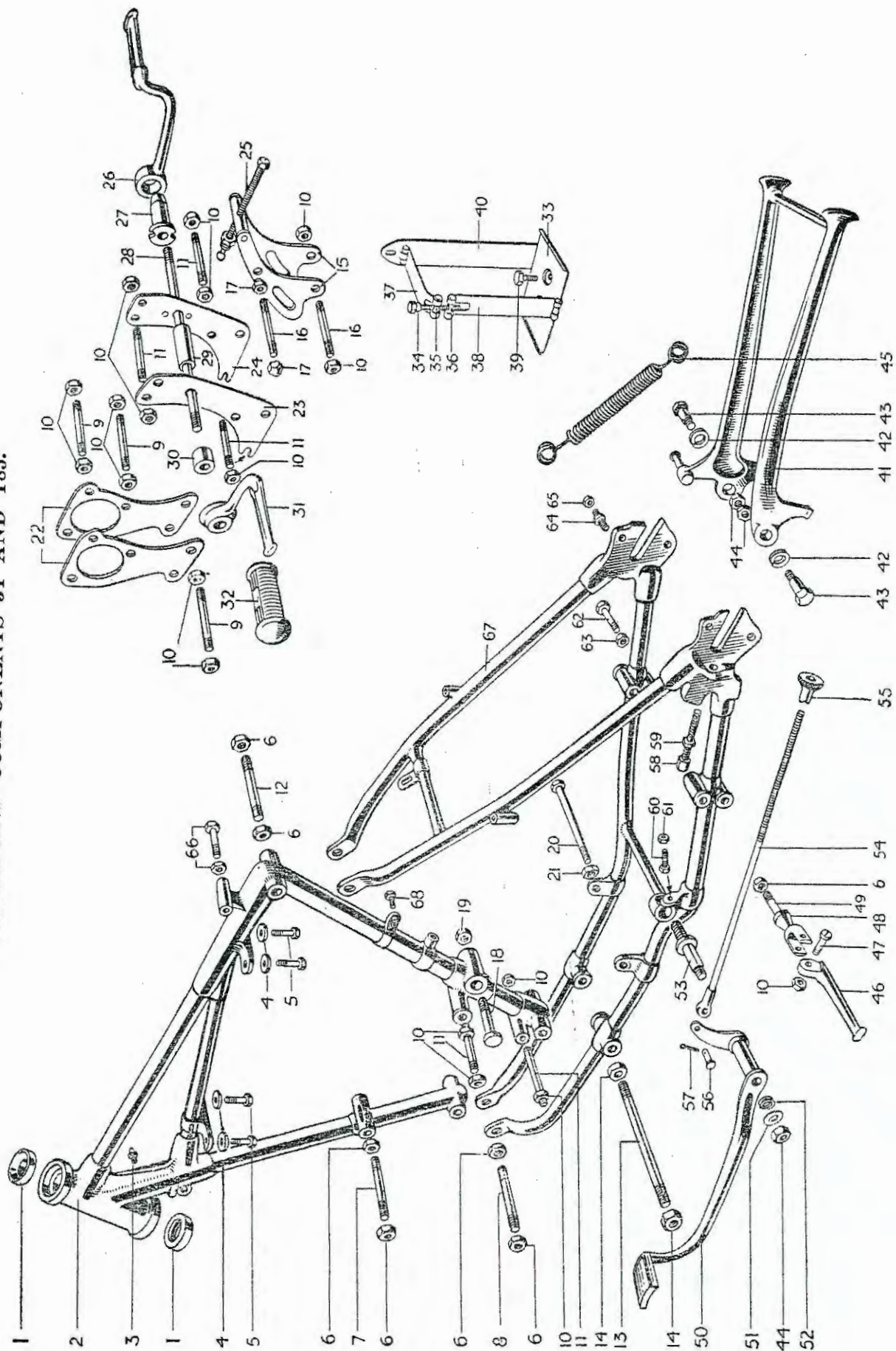

INDEX TO ILLUSTRATION ON PAGE 27

1. H438	28. F1813	54. F839
2. F2400	29. F967	55. T456
3. H111	30. F1808	56. T717
4. E1451	31. F1671	57. T461
5. F1841	32. F966	58. T275
6. DS47	33. F1213	59. F1731
7. F2414	34. F1682	60. F1736
8. F1680	35. F839	61. F991
9. F994	36. F929	62. F862
10. S1-30	37. NW100	63. T87
11. F1153	38. S4-13	64. F1711
12. S1-51	39. F1681	65. E2223
13. S25-2	40. T430	66. E2222
14. S26-16	41. F1149	67, 68. NA64J
15. F867	42. F969	69. NF704
16. 1/16" x 1/2" split pin	43. F1824	70. E536
17. WF32	44. T224	71. E534
18. E1694	45. E688	72. E535
19. S1-51	46. F947	73. F1667
20. F2271	47. F946	74. F1668
21. F2268	48. F1616A	75. F975
22. F1696	49. F1670	76. F977
23. PO172A	50. F1715	77. F976
24. F1015A	51. PO172A	78. W360
25. F879	52. F1561	79. F1834
27. NS372	53. F987	

INDEX TO ILLUSTRATION ON PAGE 28

1. XS10	24. F2396	47. F2271
2. F2385	25. T275	48. F2268
3. NW100	26. F1731	49. F1696
4. F967	27. F1736	50. F1153
5. F966	28. F1092	51. S25-2
6. PO172A	29. F1081	52. S26-16
7. F1023	30. T516	53. F867
8. F1711	31. F987	54. F1015
9. E925	32. NF704	55. NS372
10. S1-51	33. F1670	56. WF32
11. E654	34. E536	57. 1/16" x 1/2" split pin
12. E1023	35. E534	58. F969
13. F994	36. E535	59. F1008
14. S1-30	37. F1667	60. F1149
15. T717	38. F1668	61. F879
16. T456	39. F1715	62. E667A
17. T461	40. F1665/6	63. T224
18. F1681	41. F1834	64. F946
19. S4-13	42. F976	65. F947
20. F2391	43. F977	66. NA64J
21. F1126	44. W630	67. E2385A
22. E2235	45. F975	68. F1213
23. F2392	46. F1694	

ENGINE PLATE GROUP

E2235	Plate, engine front	2	2	—	—
E2222	"	"	N.S.	—	—	1	1
E2223	"	"	O.S.	—	—	1	1
F2396	"	"	rear, O.S.	1	1	—	—
F1811A	"	"	O.S.	—	—	1	1
F2392	"	"	N.S.	1	1	—	—
F1811	"	"	N.S.	—	—	1	1
F1117	Dowel, "	"	O.S. plate	2	2	2	2
F2395	Cover, "	"	plate front	1	1	—	—
F2275	"	"	"	—	—	1	1
F2414	Stud, engine plate to frame front top	—	—	1	1
E1023	"	"	"	1	1	—	—
DS47	Nut, "	"	"	"	stud	—	—	2	2
PO172A	"	"	"	"	"	2	2	—	—
PCW73A	Washer, "	"	"	"	"	—	—	2	2
S26-1	"	"	"	"	"	2	2	—	—
F1680	Stud, "	"	"	"	bottom	—	—	1	1
F1711	"	"	"	"	"	1	1	—	—
DS47	Nut, "	"	"	"	"	—	—	2	2
PO172	"	"	"	"	"	2	2	—	—
PCW73A	Washer, "	"	"	"	"	—	—	2	2
S26-1	"	"	"	"	"	2	2	—	—
F1711	Stud, engine plate to crankcase front	—	—	3	3
E925	"	"	"	"	"	3	3	—	—
PO172A	Nut, "	"	"	"	stud	—	—	6	6
SI-51	"	"	"	"	"	6	6	—	—
S25-3	Washer, "	"	"	"	"	6	6	—	—
F839	Stud, "	"	"	"	and frame rear	—	—	5	5
E654	"	"	"	"	"	5	5	—	—
PO172	Nut, "	"	"	"	"	—	—	10	10
SI-51	"	"	"	"	"	10	10	—	—
S26-1	Washer, "	"	"	"	"	—	—	10	10
S26-3	"	"	"	"	"	10	10	—	—

BATTERY CARRIER GROUP

F1670	Carrier assy., battery	1	1	1	1
F1665/6	Base and back assy., battery carrier	1	1	1	1
E534	Swivel, battery carrier strap, plain hole	1	1	1	1
E535	"	"	"	"	tapped hole	1	1	1	1
E536	Bolt, "	"	"	"	swivel	1	1	1	1
F1667	Strap, "	"	"	"	top	1	1	1	1
F1668	"	"	"	"	front	1	1	1	1
F1727	Pin, "	"	"	"	strap hinge	2	2	2	2
F1682	Stud, "	"	"	"	to seat tube boss	1	1	1	1
SI-51	Nut, "	"	"	"	"	1	1	1	1
F1715	Bolt, "	"	"	"	to primary cover	2	2	2	2

SEE PAGE 31 FOR FRAME BOLT POSITION, ASSEMBLY, ETC.

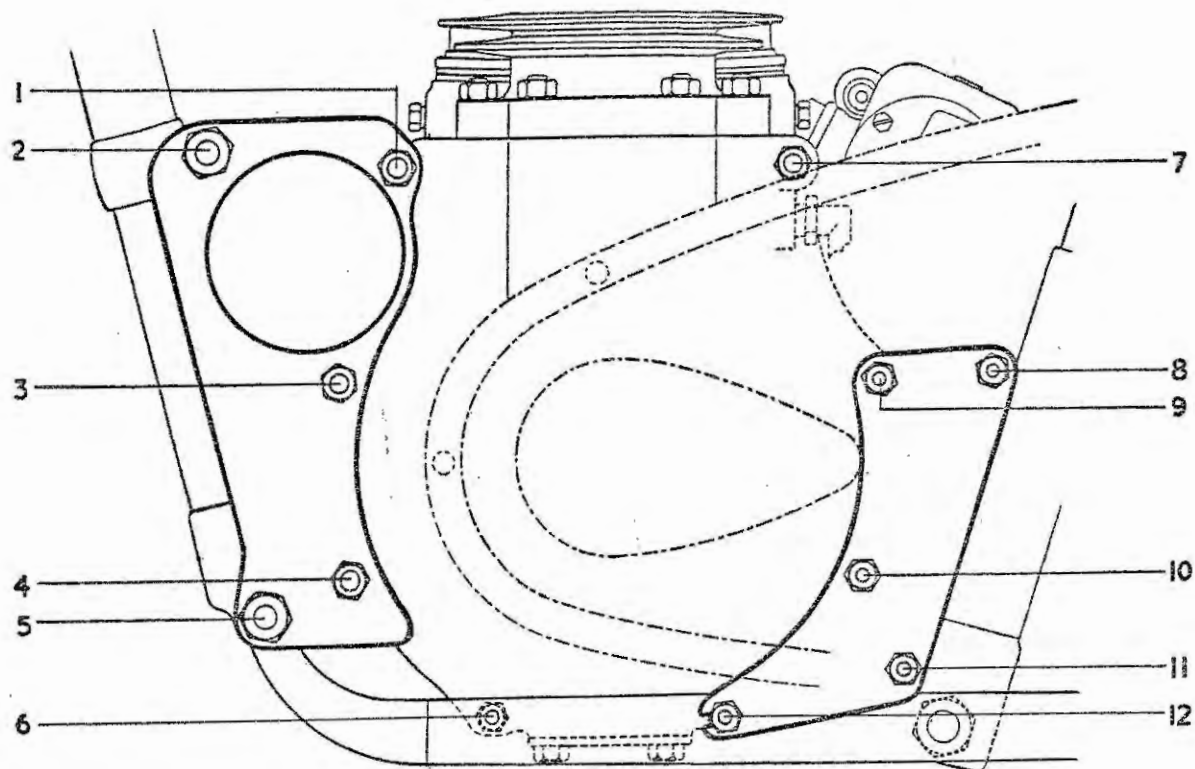

350 c.c.

1, 3, 4 & 6.	F925 S1-51 S25-3	Stud Nut Washer	5.	F1711 PO172A S26-1	Stud Nut Washer	8, 9, 10, 11 & 12	E654 S1-51 S26-3	Stud Nut Washer
2.	E1023 PO172A S26-1	Stud Nut Washer	7.	E1555 S25-3	Bolt Washer			

500 c.c.

1, 3 & 4.	F1711 PO172A S26-1	Stud Nut Washer	5.	F1680 DS47 PCW73A	Stud Nut Washer	7.	E1555 S25-3	Bolt Washer
2.	F2414 DS47 PCW73A	Stud Nut Washer	6.	T456 S1-51 S25-3	Stud Nut Washer	8, 9, 10, 11 & 12	F839 PO172A S26-1	Stud Nut Washer

CRANKCASE AND FRAME STUDS, BOLTS AND WASHERS.

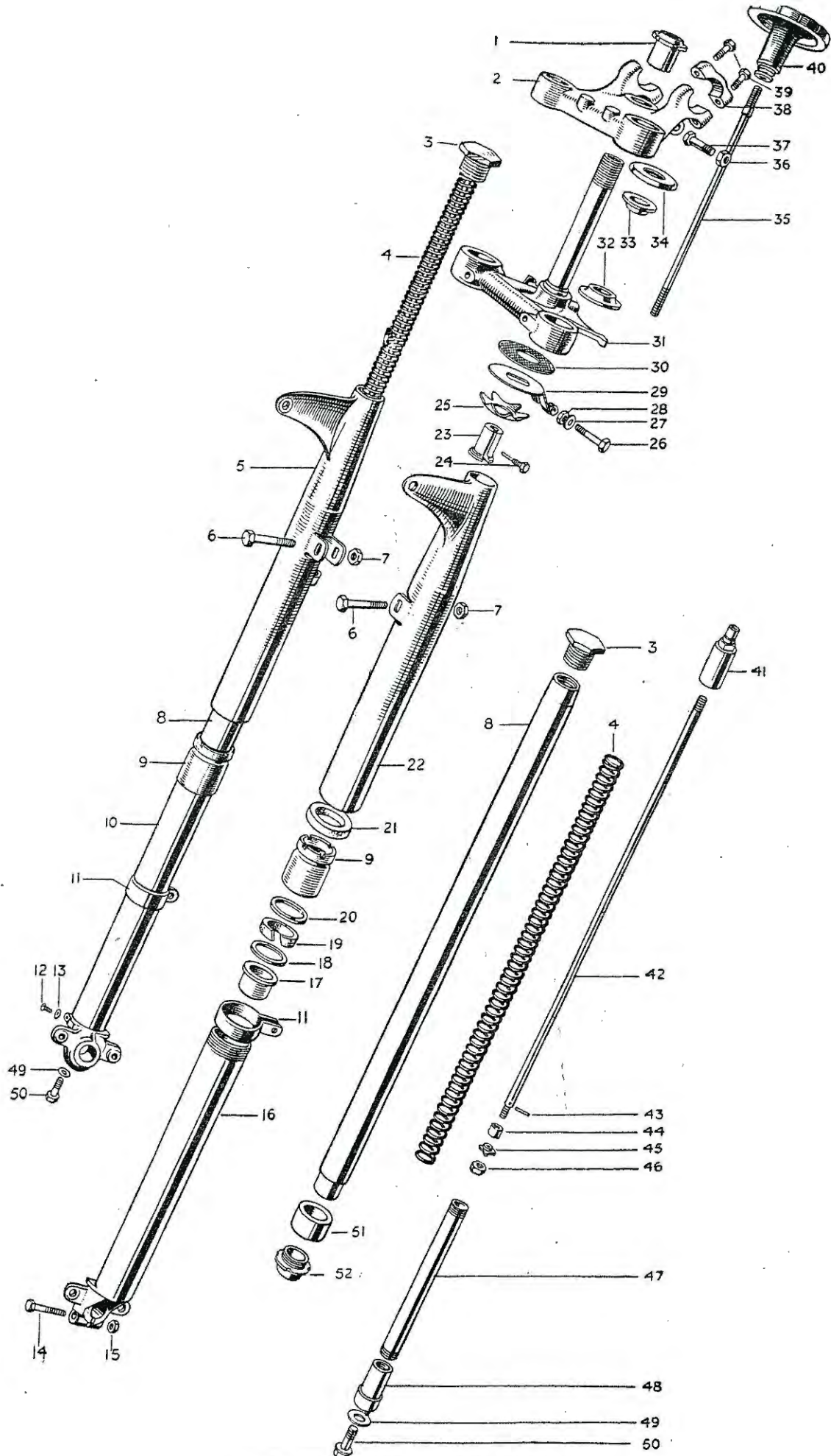

TELESCOPIC FRONT FORKS.

PART NO.	DESCRIPTION	3T	T85	5T	T100
----------	-------------	----	-----	----	------

FRONT FORK GROUP

FRONT FORK ASSY.

H501	Fork assy., c/w crown and stem and head top lug clip	1	1	—	—
H502	" " " " " " " " " " " "	—	—	1	1
H501A	Member, fork complete, N.S. ...	1	1	—	—
H502A	" " " " " " " " " " " "	—	—	1	1
H501B	" " " " " " " " " " " "	1	1	—	—
H502B	" " " " " " " " " " " "	—	—	1	1
H380	Lug, fork head top c/w handlebar caps	1	1	1	1
F1760	Bolt, head top lug pinch	1	1	1	1
H379	Nut, " " " " bolt	1	1	1	1
H506	Cap, handlebar to head top lug	2	2	2	2
H436	Bolt, handlebar cap	4	4	4	4
H402	Crown and stem, fork	1	1	1	1
H404	Nut, crown and stem sleeve	1	1	—	—
H405	" " " " " " " " " " " "	—	—	1	1
E667A	Bolt, " " " " to stanchion pinch	2	2	2	2
H518	Nut, " " " " " " " " bolt	2	2	2	2
S25-3	Washer, " " " " " " " " " "	2	2	2	2
H421	Cover, tube top with headlamp bracket, N.S.	1	1	1	1
H422	" " " " " " " " " " O.S.	1	1	1	1
H420	Washer, cover tube felt	2	2	2	2
H414	Cover tube bottom, with wheel spindle lug, N.S.	1	1	1	1
H415	" " " " " " " " " " O.S.	1	1	1	1
H519	Plug, cover tube bottom drain	2	2	2	2
H430	Washer, " " " " " " plug	2	2	2	2
F1760	Bolt, N.S. " " " " wheel lug pinch	1	1	1	1

INDEX TO ILLUSTRATION ON PAGE 32

1. H405 (500 c.c.)	17. H441	34. H407 (500 c.c.)
H404 (350 c.c.)	18. H431	H406 (350 c.c.)
2. H380	19. H391	35. H450
3. H432 (500 c.c.)	20. H445	36. H379
4. H384 (500 c.c.)	21. H420	37. F1760
H505 (Sidecar)	22. H421	38. H506
H385 (350 c.c.)	23. H408	39. H436
5. H422	24. H409	40. DS6
6. E667A	25. H95	41. H397
7. H518	26. F1718	42. H399
8. H382	27. S25-3	43. H454
9. H390	28. S1-51	44. H453
10. H415	29. H413	45. H452
11. H428	30. H435	46. F879
12. H519	31. H402	47. H394
13. H430	32. H439 (500 c.c.)	48. H395
14. F1760	XS8 (350 c.c.)	49. E1335
15. H379	33. H438 (500 c.c.)	50. H398
16. H414	H433 (350 c.c.)	51. H443
		52. H444

ALWAYS QUOTE PART NUMBER.

PART NO.	DESCRIPTION	3T	T85	5T	T100
----------	-------------	----	-----	----	------

STAND GROUP

FRONT STAND

H412	Stand assy., front	1	1	1	1
DS55	Bolt, front stand to guard	1	1	1	1
SI-51	Nut, " " " "	1	1	1	1
NS362	Nut, " " " " spigot	1	1	1	1
H424	Screw, " " " " pivot	2	2	2	2
S25-3	Washer, plain " " " "	2	2	2	2
H425	Washer, " " " " " "	2	2	2	2

REAR STAND

F1834	Rear stand assy.	1	1	1	1
F975	Spring, rear stand	1	1	1	1
F977	Bolt, " " pivot	2	2	2	2
W630	Nut, " " " bolt	2	2	2	2
F976	Washer, " " " " "	2	2	2	2

WHEELS

NOTE.—Spokes with specially angled heads ensures very sturdy wheel construction. To maintain this condition, state clearly when ordering sundry spokes:—

- Side of wheel, i.e., brake side or reverse ; N/S or O/S.
- Whether head of spoke is toward or away from wheel centre.

FRONT WHEEL GROUP

W571	Wheel, front, complete	1	1	1	1
W572	Wheel, front less bearing and brake assy.	1	1	1	1
W351	Rim, front wheel	1	1	1	1
W662	Spoke, short, $6\frac{1}{2}" \times 10G \times 83^\circ$, O.S.	10	10	10	10
W663	" " $6\frac{3}{4}" \times 10G \times 94^\circ$, O.S.	10	10	10	10
W660	" long, $8\frac{1}{2}" \times 10G \times 88^\circ$, N.S.	10	10	10	10
W661	" " $8\frac{1}{2}" \times 10G \times 90^\circ$, N.S.	10	10	10	10
S79-2	Nipple, spoke	40	40	40	40
W573	Hub, shell assy.	1	1	1	1
W576	Drum, brake assy.	1	1	1	1
W62	Bolt, brake drum	8	8	8	8
SI-51	Nut, brake drum bolt	8	8	8	8
W63	Lockplate, brake drum nut	4	4	4	4
W578	Spindle, front wheel hub	1	1	1	1
W579	Sleeve, front wheel spindle	1	1	1	1
W580	Collar, " " "	1	1	1	1
W544	Nut, " " "	1	1	1	1
W545	Washer, " " "	1	1	1	1
W653	Bearing, front wheel ball	2	2	2	2
W581	Distance piece, ball bearing	1	1	1	1
W582	Ring, ball bearing retaining	1	1	1	1
W583	Cap, ball bearing dust	1	1	1	1

THE PARAGRAPH ON SPOKES HEAD ANGLES IS IMPORTANT.

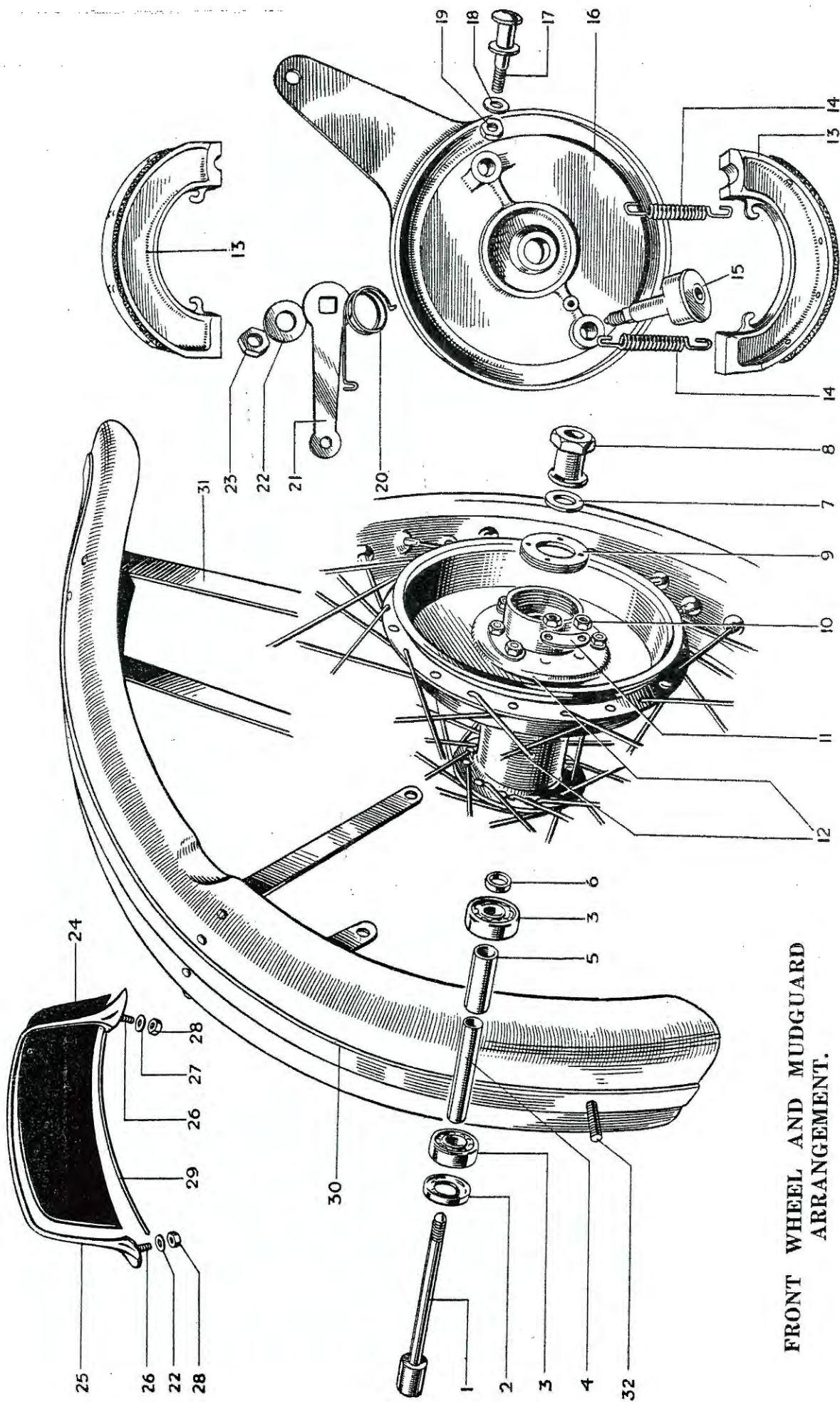

FRONT WHEEL AND MUDGUARD
ARRANGEMENT.

PART NO.	DESCRIPTION	3T	T85	5T	T100
----------	-------------	----	-----	----	------

FRONT WHEEL BRAKE

W585	Plate, front brake anchor	1	1	1	1
W588	Pin, " " shoe fulcrum	1	1	1	1
PO172A	Nut, " " " " pin	1	1	1	1
S25-2	Washer, " " " " " "	1	1	1	1
W93	Shoe, " " with lining	2	2	2	2
NW243	Lining, " " shoe	2	2	2	2
W129	Rivets, shoe lining	16	16	16	16
W135	Spring, brake shoe return	2	2	2	2
W386A	Cam assy., brake	1	1	1	1
W589	Lever, front brake cam	1	1	1	1
S1-52	Nut, " " " lever	1	1	1	1
S25-6	Washer, " " " " nut	1	1	1	1
W592	Spring, " " " " return	1	1	1	1
WF32	Pin, " " lever pivot	1	1	1	1
	Split pin, pivot pin, 1/16" X 1/2"	1	1	1	1

REAR WHEEL GROUP

W595F	Wheel, rear, complete	1	1	1	1
W595E	Wheel, rear, less bearing and brake assy.	1	1	1	1
W79A	Rim, rear wheel	1	1	1	1
NW125X	Spoke, 8 3/4" X 9G X 100°, N.S. and O.S.	20	20	20	20
NW125	Spoke, 8 3/4" X 9G X 76°, N.S. and O.S.	20	20	20	20
TW5	Nipple, spoke	40	40	40	40
W652	Hub, shell assy.	1	1	1	1
W311	Drum, rear brake	1	1	1	1
W62	Bolt, rear hub to brake drum	8	8	8	8
S1-51	Nut, hub to brake drum bolt	8	8	8	8
W63	Lockplate, nut to brake drum bolt	8	8	8	8
W61	Spindle, rear wheel hub	1	1	1	1
TS42	Nut, " " " "	2	2	2	2
W7A	Bearing, rear wheel ball	2	2	2	2

INDEX TO ILLUSTRATION ON PAGE 36

1. W578	12. W572	23. S1-52
2. W583	13. W93	24. D1914
3. W653	14. W135	25. F2599
4. W579	15. W386A	26. F1933
5. W581	16. W585	27. S26-2
6. W580	17. W588	28. F879
7. W545	18. S25-2	29. H251
8. W544	19. PO172A	30. H410A
9. W582	20. W592	31. H411
10. S1-51	21. W589	32. DS55
11. W63	22. S25-6	

BRAKE SHOES PROMPTLY RELINED.

REAR WHEEL BEARING ASSEMBLY.

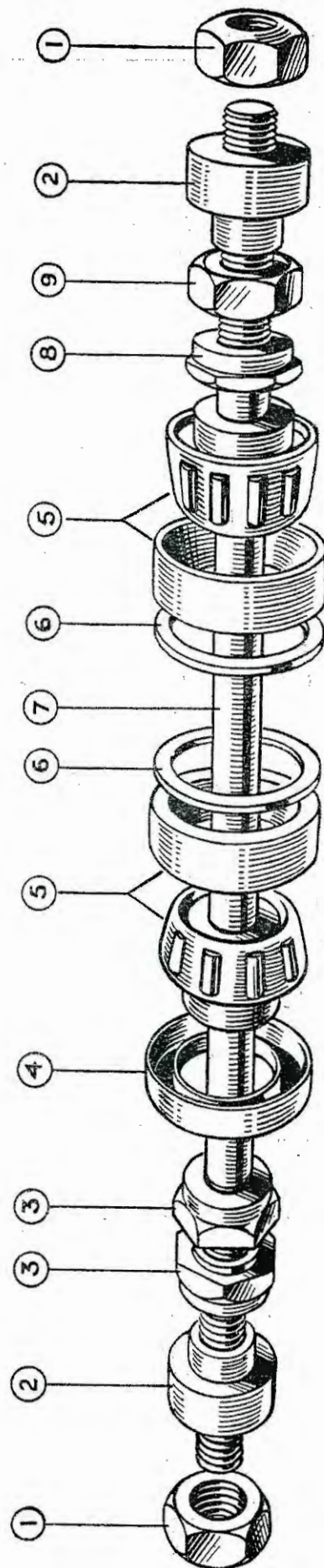

- | | | |
|---------|----------|---------|
| 1. TS42 | 4. W12 | 7. W61 |
| 2. W6 | 5. W7A | 8. W597 |
| 3. W5 | 6. NW225 | 9. W4 |

PART NO.	DESCRIPTION	3T	T85	5T	T100
NW225	Ring, ball bearing backing	2	2	2	2
W12	Cap, " " dust	1	1	1	1
W6	Collar, taking thrust to chain adjuster	2	2	2	2
W597	Nut, rear bearing adjusting	2	2	2	2
W4	Nut, " " " lock	1	1	1	1
W56	Sprocket, rear chain wheel, 46T	1	1	1	1
W64	Bolt, " " " sprocket	8	8	8	8
E2312	Washer, " " " " shakeproof	8	8	8	8

REAR WHEEL BRAKE

W125	Plate, rear brake anchor c/w brake shoes	1	1	1	1
W101	Plate, rear brake anchor	1	1	1	1
W5	Locknut, " " " plate	2	2	2	2
W93	Shoe assy., rear with lining	2	2	2	2
NW243	Lining, rear brake shoe	2	2	2	2
W129	Rivet, brake shoe lining	16	16	16	16
W135	Spring, " " return	2	2	2	2
NW234	Cam assy., rear brake	1	1	1	1
W74A	Lever, rear brake cam	1	1	1	1
S1-52	Nut, " " " lever	1	1	1	1
W123	Spring, " " " " return	1	1	1	1

MUDGUARD GROUP

FRONT MUDGUARD

H410A	Mudguard assy., front	1	1	1	1
H411	Stay, mudguard, front	1	1	1	1
H428	Clip, " support bridge	2	2	2	2
H426	Bolt, " " " clip, N.S.	1	1	1	1
H451	" " " " " O.S.	1	1	1	1
PO172A	Nut, " " " " bolt	2	2	2	2
S26-1	Washer, " " " " "	2	2	2	2
F929	Bolt, " stay to fork end	2	2	2	2
S26-3	Washer, " " " " " bolt	2	2	2	2

REAR MUDGUARD

F1722	Mudguard assy., rear	1	1	—	—
F1724	" " " " "	—	—	1	1
F1723A	Tailguard, rear mudguard with stays	1	1	—	—
F1725A	" " " " "	—	—	1	1
DS57	Bolt, tailguard, fixing	2	2	2	2
PF204	Clip, mudguard to frame	2	2	2	2
F444	Plate backing, to clip	2	2	2	2

GIVE COLOUR REFERENCE IN MUDGUARD ORDERS.

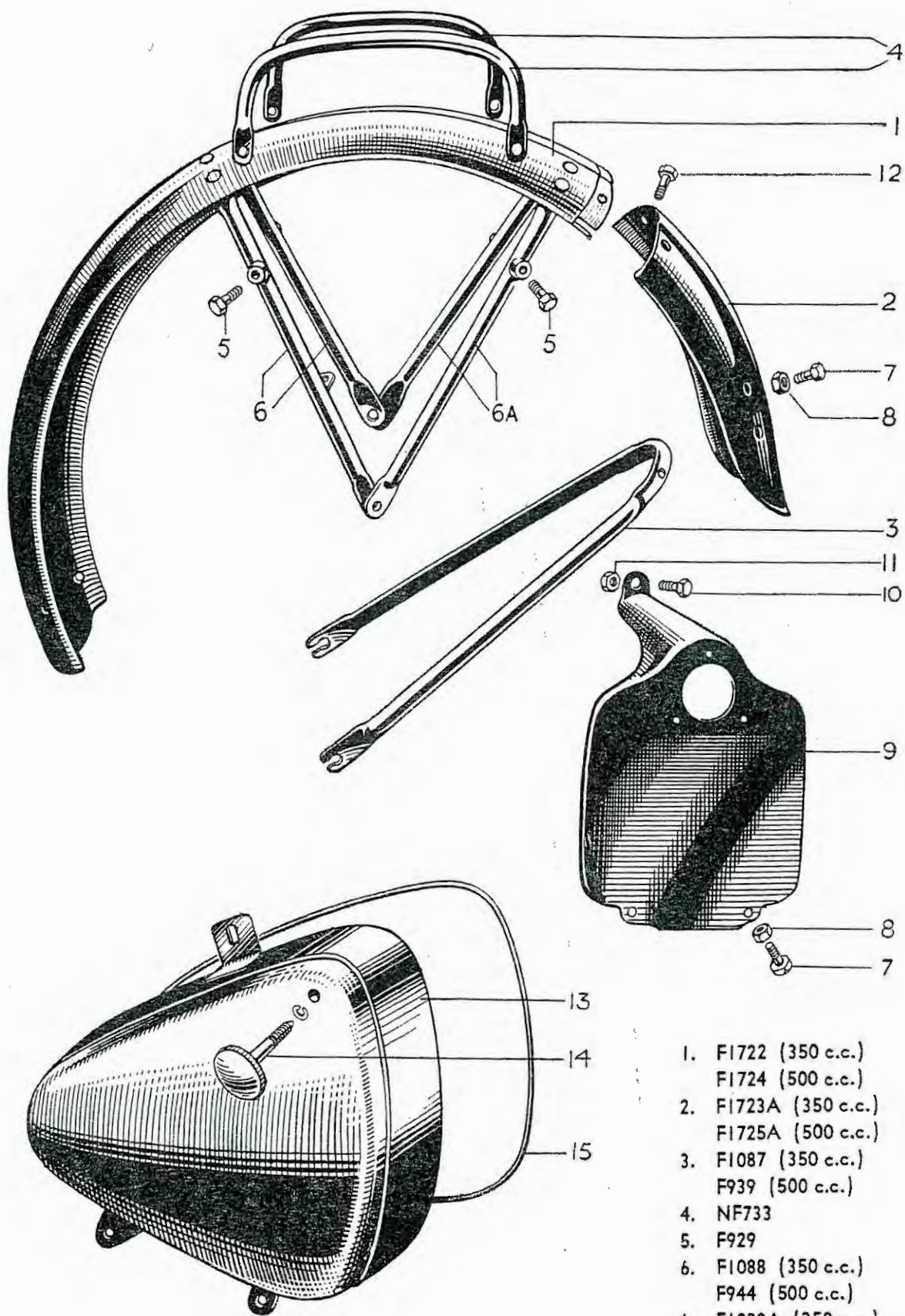

7. F1369
8. F879
9. F1822

10. F929
11. SI-51
12. DS57

13. F1692
14. F1850
15. F1735

1. F1722 (350 c.c.)
F1724 (500 c.c.)
2. F1723A (350 c.c.)
F1725A (500 c.c.)
3. F1087 (350 c.c.)
F939 (500 c.c.)
4. NF733
5. F929
6. F1088 (350 c.c.)
F944 (500 c.c.)
6a. F1088A (350 c.c.)
F944A (500 c.c.)

REAR MUDGUARD, NUMBER PLATE AND TOOLBOX.

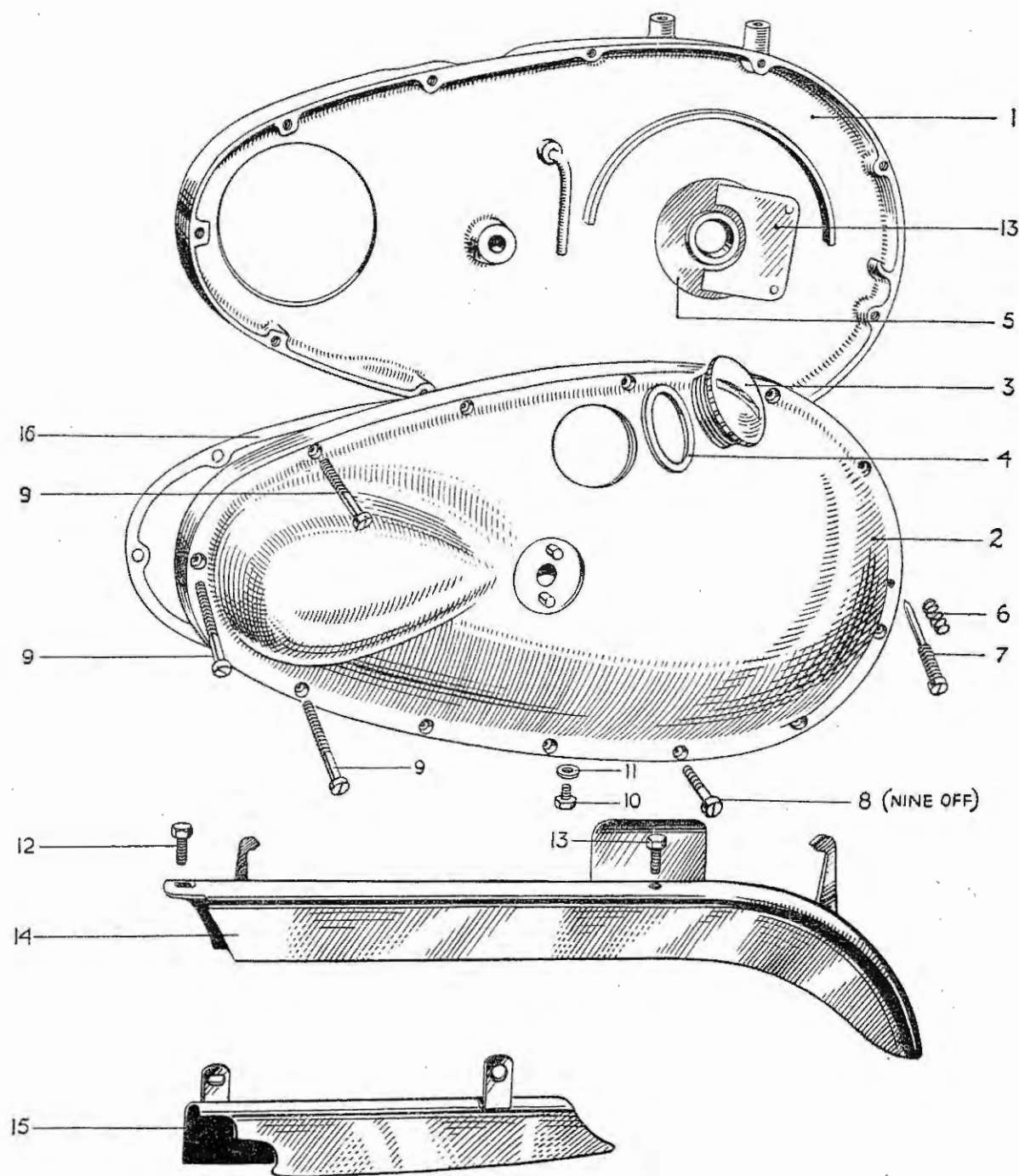

1. T725 (350 c.c.)
T483 (500 c.c.)
2. T478A (350 c.c.)
T480A (500 c.c.)
3. NT367
4. NT376
5. T484

6. T497
7. T496
8. E427
9. E329
10. PCE102F
11. WE170

12. S23-37
13. DS57
14. F1730
15. T148A
16. T503 (350 c.c.)
T504 (500 c.c.)

FRONT AND REAR CHAINCASES.

TANK GROUP

PETROL TANK

NOTE :—It is important when ordering tank to state model of machine and finish.

F1930	Tank, petrol	—	—	—	1
F1930R	" "	—	—	1	—
F1845T	" "	—	1	—	—
F1845	" "	1	—	—	—
F1034	Cap assembly, petrol tank filler	1	1	1	1
	Split pin, filler cap, 1"×3/32"	1	1	1	1
F1823	Name plate, petrol tank	—	2	—	2
F1823B	" " " "	—	—	2	—
F1823C	" " " "	2	—	—	—
F1915	Screw, name plate	4	4	4	4
F1717	Tap, petrol	1	1	—	2
F2124	" "	—	—	1	—
F1511	Washer for petrol tap	1	1	—	2
GS367	" " " "	—	—	1	—
F1721	" U " pipe, petrol tap	1	1	—	—
F2175	Pipe, petrol feed	1	1	—	—
F2123	" " " "	—	—	1	—
F2527	" " " N.S.	—	—	—	1
F2528	" " " O.S.	—	—	—	1
F2529	" Y " adaptor assy. at carb.	—	—	—	1
F2120	Pipe, connecting assy.	—	—	1	—
F2593	Adaptor for connecting pipe	—	—	1	—
GS367	Washer, connecting pipe	—	—	3	—

INDEX TO ILLUSTRATION ON PAGE 45

- | | | |
|-------------------------|----------------------|------------------|
| 1. F1034 | 9. F1792 | 19. GS367 (5T) |
| 2. 3/32" × 1" split pin | 10. F1713 | F1511 (350 c.c.) |
| 3. F1930 (T100) | 11. F1838 | 20. F1915 |
| F1930R (5T) | 12. E1948 | 21. F2091 |
| F1845T (T85) | 13. E1947 | 22. 351,552 |
| F1845 (3T) | 14. E1937 (500 c.c.) | 23. F2445 |
| 4. F1928 (500 c.c.) | E1781 (350 c.c.) | 24. 36000A |
| F1605 (350 c.c.) | 15. F2123 (5T) | 25. 56023A |
| 5. F1929 (500 c.c.) | F2175 (350 c.c.) | 26. F2577 |
| F1606 (350 c.c.) | 16. F2124 (5T) | 27. F2472 |
| *6. F1034 (T100) | F1717 (350 c.c.) | 28. F1511 (T100) |
| * E370A (350 c.c. 2 5T) | 17. F2593 (5T) | 29. F1717 " |
| *7. F1909A (T100) | 18. F2120 (5T) | 30. F2527 " |
| * F1645A | F1721 (350 c.c.) | 31. F2528 " |
| 8. PT104B | | 32. F2529 " |

See Page 46 for instructions regarding ordering.

ALWAYS GIVE COLOUR WHEN ORDERING A TANK.

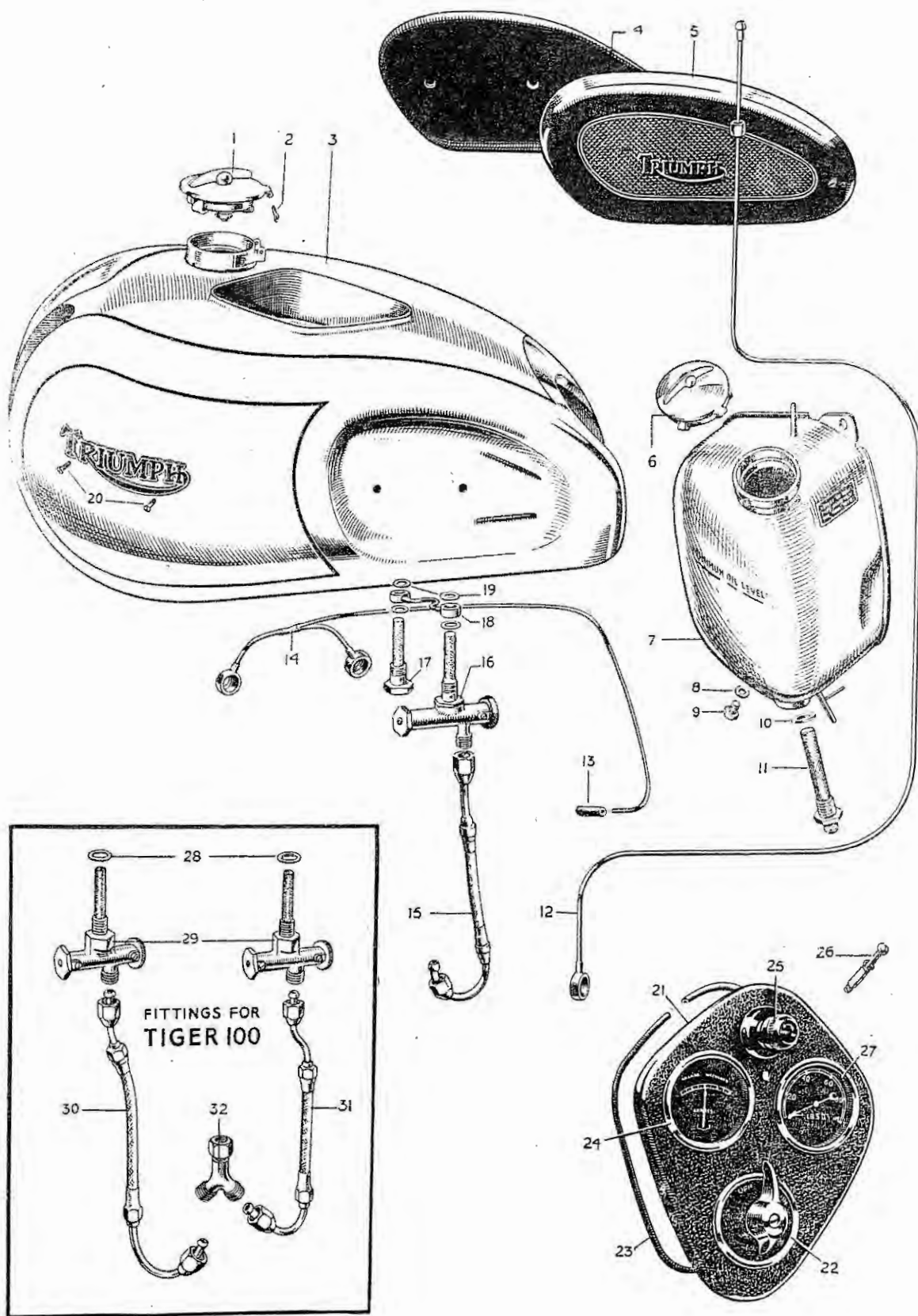

PETROL AND OIL TANKS WITH FITTINGS.

PART NO.	DESCRIPTION	3T	T85	5T	T100
F1605	Pad, knee grip, O.S.	1	1	—	—
F1606	" " " N.S.	1	1	—	—
F1928	" " " O.S.	—	—	1	1
F1929	" " " N.S.	—	—	1	1
F1607A	Plate, knee grip pad, O.S.	1	1	—	—
F1607	" " " " N.S.	1	1	—	—
T361	Screw, " " " plate	4	4	—	—
F1953	" " " " " "	—	—	4	4
F1335	Washer, " " " " screw	—	—	4	4
F966	Bolt, petrol tank fixing	4	4	2	2
F1808	" " " " front	—	—	2	2
S25-27	Washer, " " " bolt	4	4	4	4
F967	Pad, " " " rubber	8	8	6	6
F1813	" " " " " "	—	—	2	2

OIL TANK

F1645A*	Tank, oil, complete, with screwed filler	1	1	1	—
F1909A*	" " " " hinged filler	—	—	1	1
E370A	Cap, oil tank filler	1	1	1	—
F1034	" " " " c/w washer	—	—	1	1
E1331	Washer, oil tank filler cap	1	1	1	—
F1792	Plug, " " " drain	1	1	1	1
PT104B	Washer, " " " plug	1	1	1	1
F2330	Tube, " " " vent (copper)	1	1	1	—
F2323	Union, " " " tube	1	1	1	—
F1758	Tube, " " " (rubber)	—	—	1	1
F929	Bolt, oil tank to bridge clip	1	1	1	1
F1213	" " " " seat tube clip	1	1	—	—
F2596	" " " " " " " "	—	—	1	—
F1335	Distance washer, oil tank to seat tube bolt	1	1	—	—
F2597	" " " " " " " "	—	—	1	—
F1682	Stud, oil tank to seat tube	1	1	1	1
S1-51	Nut, " " " " " stud	1	1	1	1
F1838	Filter, oil tank	1	1	1	1
F1713	Washer, " " " filter	1	1	1	1
F1919*	Pipe, feed assy., top half	—	—	1	1
F1839*	" " " " " " " "	1	1	1	—
S63-1	Union nut, feed pipe assy.	1	1	1	1
E1958*	Oil pipes and block oil tank to engine	—	—	1	1
E1526*	" " " " " " " "	1	1	1	—
E1529	Washer, oil pipe block joint	1	1	1	1
S1-51	Nut, oil pipe block	1	1	1	1
S25-3	Washer, oil pipe block stud	1	1	1	1
MF119	Connection, oil tank to oil pipe	2	2	2	2

* Note that F1909A Oil Tank (Hinged Filler) with F1919 and E1958 Oil Pipes was fitted to early 5T models and F1645A Oil Tank (Screwed Filler) with F1839 and E1526 Oil Pipes to later machines.

ALWAYS GIVE COLOUR WHEN ORDERING A TANK.

PART NO.	DESCRIPTION	3T	T85	5T	T100
----------	-------------	----	-----	----	------

HANDLEBAR GROUP

HANDLEBAR

H241	Handlebar, complete with controls and twist grip ...	1	1	1	1
H225	Handlebar bend only ...	1	1	1	1
H230	Grip, dummy rubber, L.H. ...	1	1	1	1

THROTTLE CONTROL

H240	Twist grip assy. ...	1	1	1	1
H230	Grip, twist rubber ...	1	1	1	1
H228	Head, twist grip ...	1	1	1	1
H237	Grub screw, twist grip ...	1	1	1	1
H231/29	Sleeve, twist grip ...	1	1	1	1
H233	Plate, twist grip retaining ...	2	2	2	2
H232	Circlip, twist grip plate...	1	1	1	1
H235	Plunger, twist grip ...	1	1	1	1
H236	Spring, twist grip plunger ...	1	1	1	1
H234	Thimble, twist grip cable ...	1	1	1	1

FRONT BRAKE CONTROL

18/547	Lever, control assy. ...	1	1	1	1
18/535	Lever only ...	1	1	1	1
18/174	Bracket, lever ...	1	1	1	1
12/044	Clamp, bracket lever ...	1	1	1	1
11/014	Screw, lever clamp ...	2	2	2	2
18/087	Pin, lever fulcrum ...	1	1	1	1
18/053	Nut, " " pin ...	1	1	1	1
70/016	Washer, " " " ...	1	1	1	1

CLUTCH CONTROL

18/546	Lever, control assy. ...	1	1	1	1
18/528	Lever only ...	1	1	1	1
18/174	Bracket, lever ...	1	1	1	1
12/044	Clamp, bracket lever ...	1	1	1	1
11/014	Screw, lever clamp ...	2	2	2	2
18/087	Pin, lever fulcrum ...	1	1	1	1
18/053	Nut, " " pin ...	1	1	1	1
70/016	Washer, " " " ...	1	1	1	1

FIGURE IN MODEL COLUMN DENOTES QUANTITY PER MACHINE.

HANDLEBARS AND CONTROLS.

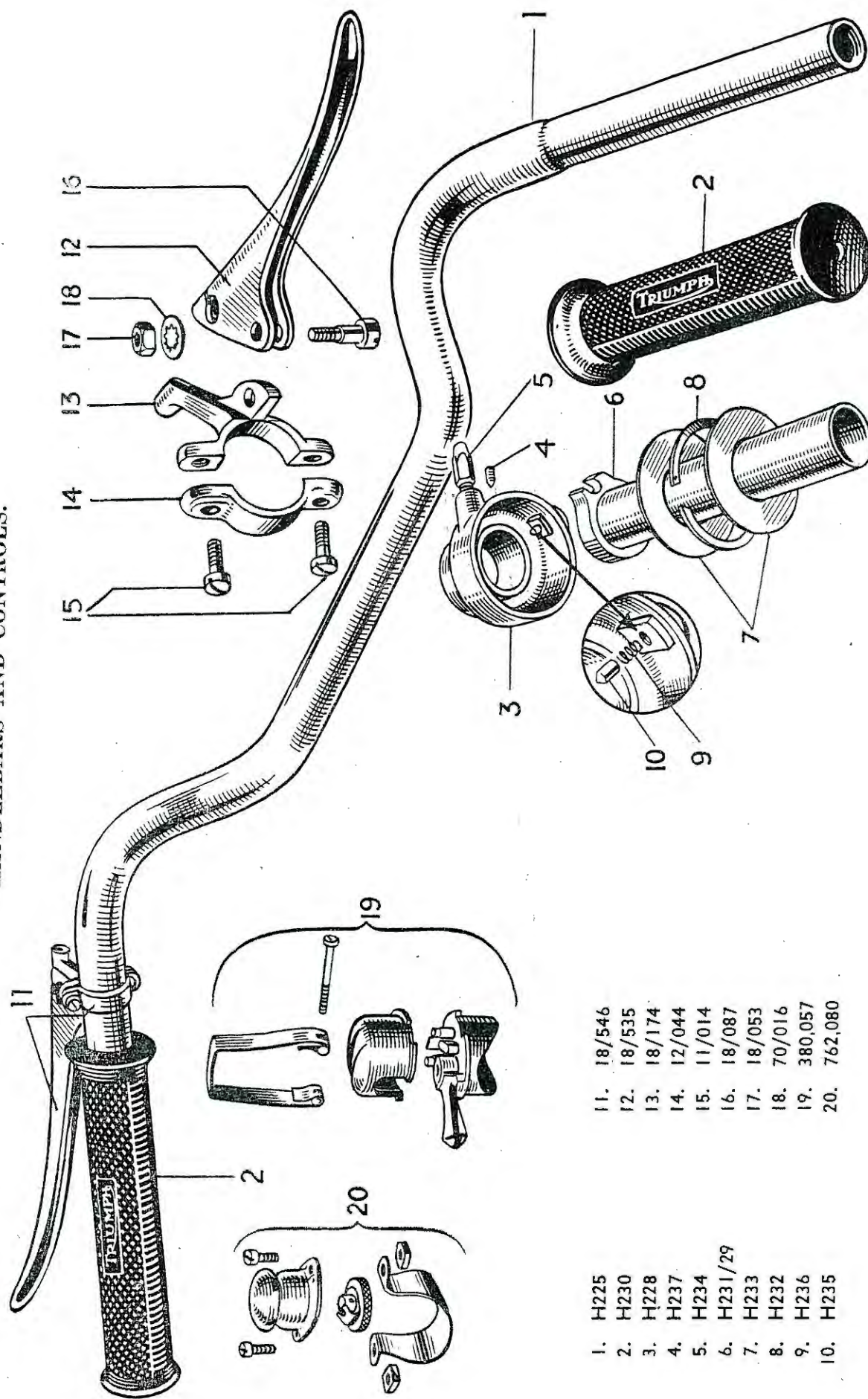

- 1. 18/546
- 2. 18/535
- 3. 18/174
- 4. 12/044
- 5. 11/014
- 6. 18/087
- 7. 18/053
- 8. 70/016
- 9. 380,057
- 20. 762,080

- 1. H225
- 2. H230
- 3. H228
- 4. H237
- 5. H234
- 6. H231/29
- 7. H233
- 8. H232
- 9. H236
- 10. H235

PART NO.	DESCRIPTION	3T	T85	5T	T100
----------	-------------	----	-----	----	------

CONTROL CABLE GROUP

CLUTCH CABLE

D203/X	Cable assy., clutch	1	1	1	1
D203W	Wire only, "	1	1	1	1
D203C	Cable only, "	1	1	1	1
D103	Ferrule, clutch casing	2	2	2	2
18/088	Nipple, clutch wire (handlebar end)	1	1	1	1
DS73	Nipple (gearbox end)	1	1	1	1
DS74	Adjuster, clutch cable	1	1	1	1
W76	Locknut, clutch cable adjuster	1	1	1	1

FRONT BRAKE CABLE

D204/X	Cable assy., brake	1	1	1	1
D204W	Wire only, brake	1	1	1	1
D204C	Casing only, brake	1	1	1	1
D103	Ferrule, brake casing	2	2	2	2
18/088	Nipple, brake wire (handlebar end)	1	1	1	1
H446	Tube, brake wire	1	1	1	1
W593	Fork end, brake wire	1	1	1	1
H447	Cable end, brake	1	1	1	1
W328	Adjuster, cable	1	1	1	1
W591	Abutment, cable adjuster	1	1	1	1
W329	Thumb nut, cable adjuster	1	1	1	1

THROTTLE CABLE

D89/X	Cable assy., throttle	—	—	1	1
D78/X	" " "	1	1	—	—
D89W	Wire only, throttle	—	—	1	1
D78W	" " "	1	1	—	—
D89C	Casing only, throttle	—	—	1	1
D78C	" " "	1	1	—	—
D101	Ferrule, throttle casing	2	2	2	2
D83	Nipple, throttle (handlebar end)	1	1	1	1
5/204	Nipple, screws throttle (carburettor end)	1	1	1	1
D104	Cable, adjuster assembly	—	—	1	1
XA69	Clip for cables	8	8	8	8

REAR BRAKE CONTROL GROUP

F1153	Pedal, rear brake	1	1	1	1
F995	Rubber, brake pedal	1	1	1	1
F1149	Screw, " " stop	1	1	1	1
F879	Nut, " " " screw	1	1	1	1
F867	Spindle, " " "	1	1	1	1
DS48	Nut, " " spindle to frame...	1	1	1	1

PRICES DO NOT INCLUDE POSTAGE OR CARRIAGE.

PART NO.	DESCRIPTION	3T	T85	5T	T100
SCZ45	Washer, brake pedal spindle to frame ...	1	1	1	1
SI-52	Nut, " " " pedal end ...	1	1	1	1
S25-2	Washer, " " " " " plain ...	1	1	1	1
S26-16	Washer, " " " " " spring ...	1	1	1	1
FI015	Rod, brake operating, assembly ...	1	1	—	—
FI015A	" " " " " ...	—	—	1	1
WF32	Pin, brake rod fork end pivot ...	1	1	1	1
	Split pin, 1/16" × 1/2" ...	1	1	1	1
W11	Pin, brake rod to cam lever hinge ...	1	1	1	1
NS372	Nut, " " adjusting ...	1	1	1	1

FOOTREST GROUP

FI731	Footrest, O.S. ...	1	1	1	1
F987	" N.S. ...	1	1	1	1
NF704	Rubber, footrest ...	2	2	2	2
FI736	Tube, footrest support, O.S. ...	1	1	1	1
F991	Rod, footrest ...	—	—	1	1
FI092	" " ...	1	1	—	—
DS48	Nut, " rod ...	2	2	2	2
S25-8	Washer, " " O.S. (plain) ...	1	1	1	1
FI081	Tube, distance, footrest rod ...	1	1	—	—
F862	" " " " ...	—	—	1	1

PILLION FOOTREST

F2312	Footrest assy., pillion ...	2	2	2	2
FI694	Pedal, footrest ...	2	2	2	2
FI695	Rubber, " pedal ...	2	2	2	2
F2271	Bolt, " " pivot ...	2	2	2	2
SI-51	Nut, " " " bolt ...	2	2	2	2
F2277	Washer, " " " " ...	2	2	2	2
F2268	Hanger, " " N.S. ...	2	2	2	2
FI696	Stud, " " hanger ...	2	2	2	2
PO172A	Nut, " " " stud ...	2	2	2	2
S26-1	Washer, " " " " ...	2	2	2	2

SADDLE GROUP

FI897	Saddle complete ...	1	1	—	—
FI729T	" " ...	—	—	1	1
FI729D	Spring, saddle main coil ...	2	2	2	2
FI729F	" " " " 7 3/4" ...	AS REQUIRED			
FI729G	" " " " 7 1/4" ...	" "			
FI729H	" " " " 7" ...	" "			
FI729I	" " " " 6 5/8" ...	" "			
FI729J	" " " " 6 1/4" ...	" "			

LETTERS FORMING PART OF ENGINE NUMBER ARE IMPORTANT.

PART NO.	DESCRIPTION	3T	T85	5T	T100
FI729A	Cover, saddle	—	—	1	1
FI897A	" "	1	1	—	—
F847	Stud, saddle spring to frame	2	2	2	2
W76	Nut, " stud	8	8	8	8
S25-2	Washer, " "	6	6	6	6
NA64J	Saddle nose nut and bolt	1	1	1	1

PILLION SEAT GROUP

NF761	Seat, pillion, complete	1	1	1	1
S23-42	Bolt, pillion seat fixing	2	2	2	2
S4-9	Nut, " " bolt	2	2	2	2
S25-1	Washer, " " "	2	2	2	2

TOOL BOX GROUP

FI692	Tool box, complete	1	1	1	1
FI735	Ring, sealing	1	1	1	1
FI850	Screw, fastener complete	1	1	1	1
WF352	Circlip, " screw	1	1	1	1
FI700	Clip, toolbox to frame	2	2	1	1
FI699	Clip, toolbox to frame	—	—	1	1
FI369	Bolt, " " " clip	2	2	2	2
F879	Nut, " " " " bolt	2	2	2	2

TOOL KIT GROUP

DA71	Tool roll complete	—	—	1	1
D209	" " "	1	1	—	—
DA72	Spanner, .920" × 1.010", open	1	1	1	1
KA50	" .375" × .338" "	1	1	1	1
NA55	" .600" × .525" "	1	1	1	1
DA16	" .820" × .712" "	1	1	1	1
NA66	" .600" × .448", closed	1	1	1	1
PA57	" .919" × 1.011" "	1	1	1	1
PA60	" box, complete	1	1	1	1

SEE SPECIMEN ORDER IN PREFACE.

PART NO.	DESCRIPTION	3T	T85	5T	T100
DA5	Spanner, rocker adjusting screw				
NA65	" .448" hex. X .218" sq.	—	—		
PA56	" combination				
DA21	Bar, tommy				
DA87	Spanner, sparking plug				
DA70	Key, clutch adjusting				
DA50/1	Extractor, clutch centre				
NA12	Gun, grease				
NA14A	Lever, tyre				
PA55	Screwdriver				
167	Extractor, chain rivet (not included in tool kit)				
WA58	Roll, tool				
D49	Inflator, tyre				

SPEEDOMETER GROUP

S433/3/L cpte.	Speedometer, 120 m.p.h. trip, cpte.	—	—		
S464/3/L cpte.	" " " " " (with rev. indicator)	—	—		
S433/1/L cpte.	Speedometer, 80 m.p.h. trip, cpte.			—	—
S464/1/L cpte.	" " " " " (with rev. indicator)			—	—
S433/5/L cpte.	" 140 kilo " " " " " " "			—	—
S433/7/L cpte.	" 180 kilo " " " " " " "	—	—		
S433/3/L	" 120 m.p.h. " head only	—	—		
S464/3/L	" " " " " " (with rev. indicator)	—	—		
S433/1/L	" 80 m.p.h. " " " " " " "			—	—
S464/1/L	" " " " " " (with rev. indicator)			—	—
S433/5/L	" 140 kilo " " " " " " "			—	—
S433/7/L	" 180 kilo " " " " " " "	—	—		
DS40	Bracket, speedometer mounting				
DS57	Screw, speedometer mounting bracket				
S26-2	Washer, " " " " " " "				
D175	Gearbox, speedometer rear wheel				
D176	Cable, speedometer drive (54" long)	—	—		
D176A	" " " (52" long)			—	—

SPARKING PLUG

H14S	Plug, sparking (Lodge)	2	2	2	2
D105	Cover, sparking plug	2	2	2	2

FRAME NUMBER IS ON FRONT TOP OF HEAD LUG.

CARBURETTER GROUP

D205	Carburetter complete	1	—	—	—
D206	" "	—	1	—	—
D207	" "	—	—	1	—
D212	" "	—	—	—	1
275/014R	Chamber, mixing	1	1	—	—
276/410R	" "	—	—	1	—
276/411R	" "	—	—	—	1
4/031	Cap, mixing chamber	1	1	—	—
6/031	" " "	—	—	1	1
4/062	Nut, mixing chamber union	1	1	—	—
6/062	" " " "	—	—	1	1
4/235	Spring, mixing chamber cap	1	1	—	—
6/248	" " " "	—	1	—	—
4/276	" " " "	—	—	—	1
4/241	Screw, mixing chamber cap spring	1	1	1	1
5/503	Air valve, assembly	1	1	—	—
6/417	" " "	—	—	1	1
5/074/5/4	Valve throttle	1	—	—	—
5/074/5/3	" " "	—	1	—	—
6/074/6/3	" " "	—	—	1	1
4/263	Spring, throttle valve	1	1	1	1
4/063	Screw, throttle valve adjusting	1	1	1	1
16/010	Nut, throttle valve adjusting screw	1	1	1	1
13/129	Screw, air adjusting	1	1	1	1
4/148	Spring, air adjusting screw	1	1	1	1
4/042	Jet, main No. 120	1	1	—	—
4/042	" " " 140	—	—	1	—
4/042	" " " 160	—	—	—	1
205/058R	Block, jet	1	1	—	—
206/057R	" " "	—	—	1	—
206/058R	" " "	—	—	—	1
4/040	Washer, jet block	1	1	—	—
6/040	" " "	—	—	1	1
4/061	Jet, for needle (Standard 1065)	1	—	—	—
4/061	" " " (107)	—	1	1	1
5/065	Needle for jet (No. 5)	1	1	—	—
6/065	" " " (No. 6)	—	—	1	1
4/230	Clip, jet needle	1	1	1	1
4/043	Bolt, holding	1	1	1	1
4/053	Washer, holding bolt	2	2	2	2
204/038R	Tube, air intake	1	1	—	—
206/038R	" " "	—	—	1	1
4/035	Adjuster, throttle cable	1	1	—	—
1A	Chamber, float (complete)	1	1	—	—
1AT	" " (")	—	—	1	1

ENGINE NUMBER IS IMPRESSED ON DRIVING SIDE OF CRANKCASE.

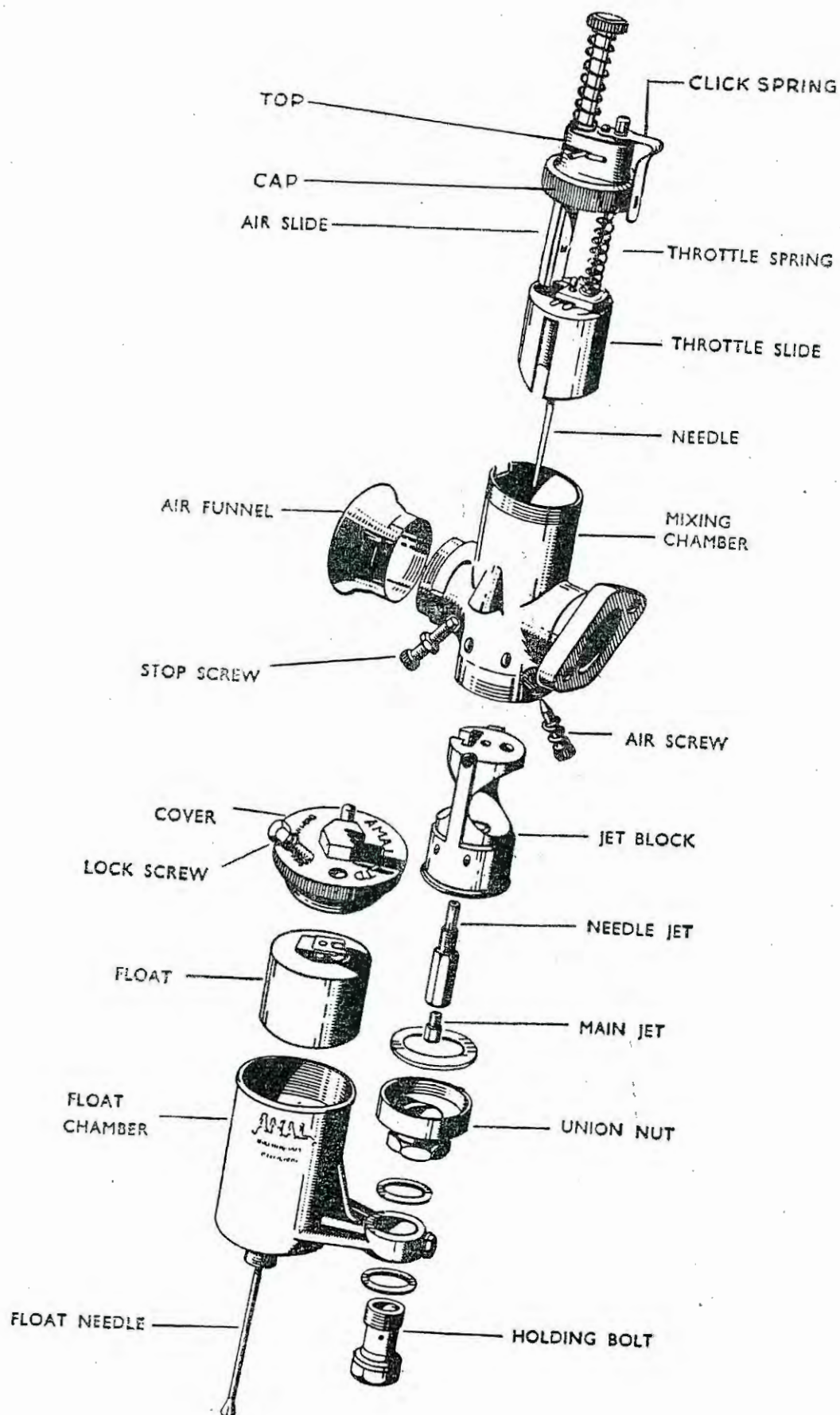

Amal Carburettor Parts

PART NO.	DESCRIPTION	3T	T85	5T	T100
64/156	Body, float chamber			—	—
64/192	" " "	—	—		
14/208	Cover, " "				
14/021	Lock-screw, float cover				
14/015	Float				
14/024	Needle, valve				
14/209	Tickler				
14/210	Stop, tickler				
14/032	Spring, "				
4/060	Cotter, "				
13/153	Screw, platform plug				
14/039	Washer, platform plug screw				
14/178	Locknut, seating				
14/175	Washer, seating locknut				
14/042	Nut, petrol union				
14/026	Nipple, " "				
6/132	Ferrule, mixing chamber top	—	—		
NA48	Washer, carburetter flange			—	—
NA43	" " "	—	—		—
NA43A	" " "	—	—	—	

MAGNETO (B.T.H.) GROUP

DI52	Magneto, less auto advance				
CZ87157-G2	Housing, magneto main				
SKC741-G1	Ball race	2	2	2	2
SKC6123-I	Insulation washer, ball race	2	2	2	2
CR22186-I	Washer, bearing adjusting				
CR22315-I	Washer, oil retaining				
CR23042-I	Magnet				
SKC6245-I	Screw, magnet locating	2	2	2	2
SKC24291-I	Cover, magnet				
3BA5/16" Rd. Hd.	Screw, magnet cover fixing	2	2	2	2
SKC9952-8	Washer, magnet cover fixing	2	2	2	2
CR23290-I	Screw, safety gap				
SKC67991-I	Tab, safety gap screw, locking				
SKC87159-G1	Holder, collector brush	2	2	2	2
SKC6306-G2	Collector brush and spring	2	2	2	2
CR87404-I	Washer, collector holder sealing	2	2	2	2
CR87160-I	Nut, collector holder ring	2	2	2	2
CZ60707-G19	Cable, H.T.	2	2	2	2
SKC6397-I	Screw, H.T. cable securing	2	2	2	2
E2415	Clip, H.T. cable				
CR87403-I	Ferrule, collector holder rubber	2	2	2	2
CY50495-G1	Armature c/w condenser and end plate				
SKC6115-I	Screw, armature end plate to core	4	4	4	4
SKC6111-I	Dowel, armature end plate locating				

DON'T FORGET TO SIGN YOUR ORDER.

PART NO.	DESCRIPTION	3T	T85	5T	T100
SKC6114-1	Screw, armature end plate securing ...	4	4	4	4
SKC6112-1	Dowel, armature end plate locating ...	1	1	1	1
CY52078-G3	Condenser, assembly ...	1	1	1	1
SKC6636-1	Insulation, condenser (large) ...	2	2	2	2
SKC6637-1	Insulation, condenser (small) ...	2	2	2	2
4BAX5/16" Ch.Hd.	Screw, condenser securing ...	2	2	2	2
SKC9952-6	Washer, condenser screws ...	2	2	2	2
CR20776-1	Bush, condenser insulating ...	1	1	1	1
SKC6612-G1	Slip ring ...	1	1	1	1
SKC6122-1	Washer, slip ring, plain ...	1	1	1	1
SKC6180-1	Washer, slip ring, spring ...	1	1	1	1
CR20774-1	Ring, reinforcing ...	1	1	1	1
CX1883-G24	Contact breaker L.H. complete ...	1	1	1	1
SKC74955-G2	Base and check spring assy., contact breaker ...	1	1	1	1
CZ63472-G2	Lever contact and springs ...	1	1	1	1
SKC6215-1	Spring, contact breaker run forcing ...	2	2	2	2
SKC6208-1	Screw, contact breaker spring ...	2	2	2	2
CR29708-1	Wick, contact breaker lever ...	1	1	1	1
SKC29303-G1	Contact, adjustable screw ...	1	1	1	1
SKC6216-1	Nut, adjustable screw contact ...	1	1	1	1
SKC9952-8	Washer, adjustable screw contact ...	1	1	1	1
SKC6235-1	Block, contact screw locating ...	1	1	1	1
SKC6213-1	Strip, insulating block ...	1	1	1	1
SKC6209-1	Screw, block securing ...	1	1	1	1
SKC6210-1	Bush, screw insulating ...	1	1	1	1
SKC6212-1	Bush, block centre ...	1	1	1	1
SKC6219-G1	Brush and spring contact breaker earthing ...	1	1	1	1
SKC6214-1	Spring, contact breaker main ...	1	1	1	1
CR29487-1	Screw, contact breaker securing ...	1	1	1	1
CZ61580-1	Cover complete, contact breaker ...	1	1	1	1
SKC28537	Cover only, contact breaker ...	1	1	1	1
CR89533-1	Bush, contact breaker, cover insulating ...	1	1	1	1
CR29456-1	Strip, contact breaker, cover insulating ...	1	1	1	1
CR29455-1	Strip, contact breaker cover contact ...	1	1	1	1
CR29459-1	Terminal, contact breaker cover contact ...	1	1	1	1
4BA Strd.	Washer, contact breaker terminal, plain ...	3	3	3	3
SKC9952-6	Washer, contact breaker terminal, spring ...	2	2	2	2
CR26513	Nut, contact breaker terminal, lock ...	1	1	1	1
CR89927-1	Nut, contact breaker terminal, knurled ...	1	1	1	1
SKC88939-6	Washer, contact breaker terminal knurled nut ...	1	1	1	1
CR28540-1	Washer, contact breaker cover sealing ...	1	1	1	1
CR28571-1	Screw, contact breaker cover securing ...	3	3	3	3
SKC9952-6	Washer, contact breaker cover screw ...	3	3	3	3
SKC33650	Cam, ring ...	1	1	1	1
SKC6344-1	Wick, cam lubricating ...	1	1	1	1
SKC28544-G3	Housing, cam ring ...	1	1	1	1
2BAX½" Inst.Hd.	Screw, cam ring housing ...	4	4	4	4
SKC88939-20	Washer, cam ring housing lock ...	4	4	4	4
CR26381-1	Screw, timing stop ...	1	1	1	1

ALWAYS QUOTE PART NUMBER.



B.T.H. MAGNETO HOUSING AND AUTO ADVANCE.

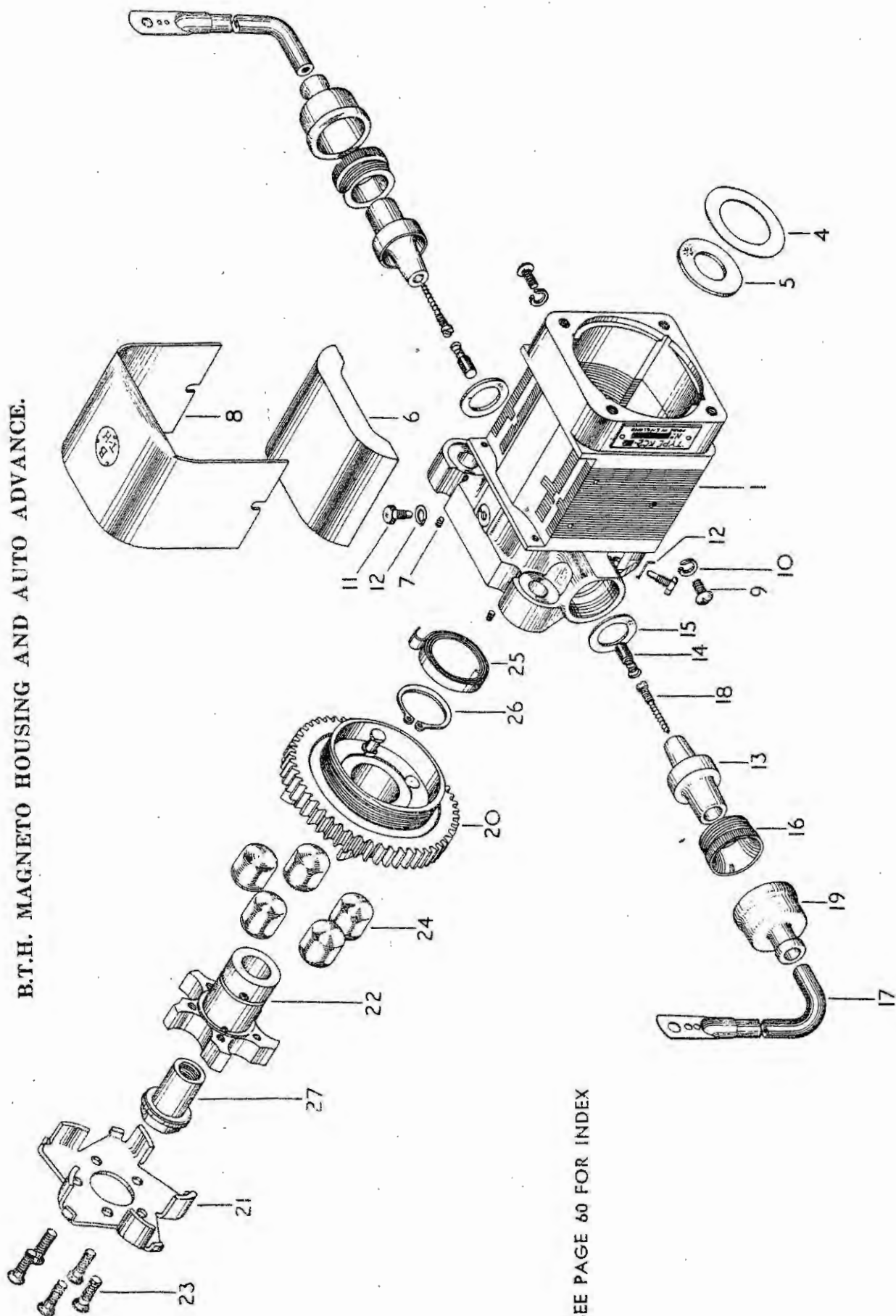

SEE PAGE 60 FOR INDEX

B.T.H. MAGNETO ARMATURE AND CONDENSER.

SEE PAGE 60 FOR INDEX

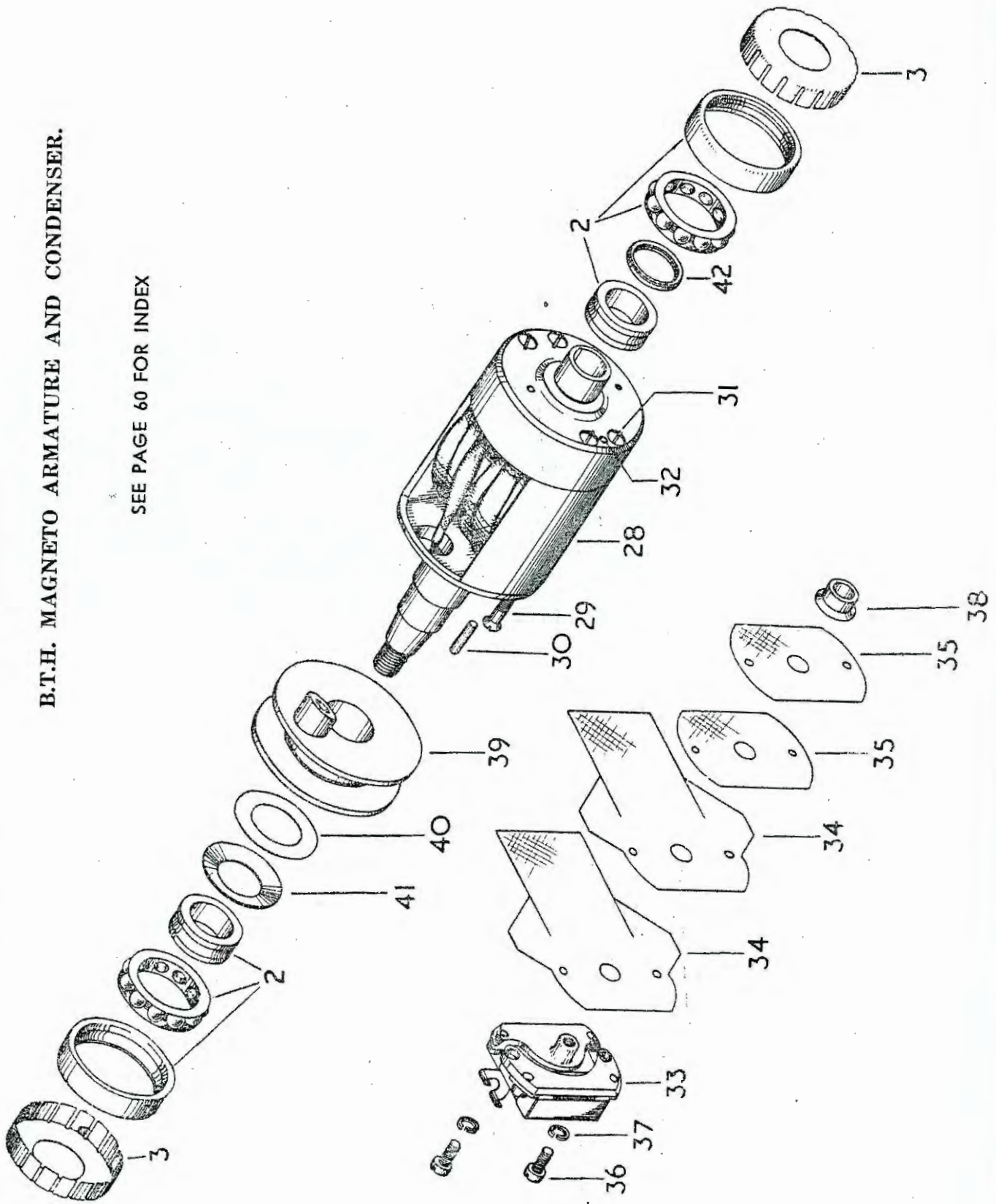

B.T.H. MAGNETO CONTACT BREAKER AND HOUSING.

SEE PAGE 60 FOR INDEX

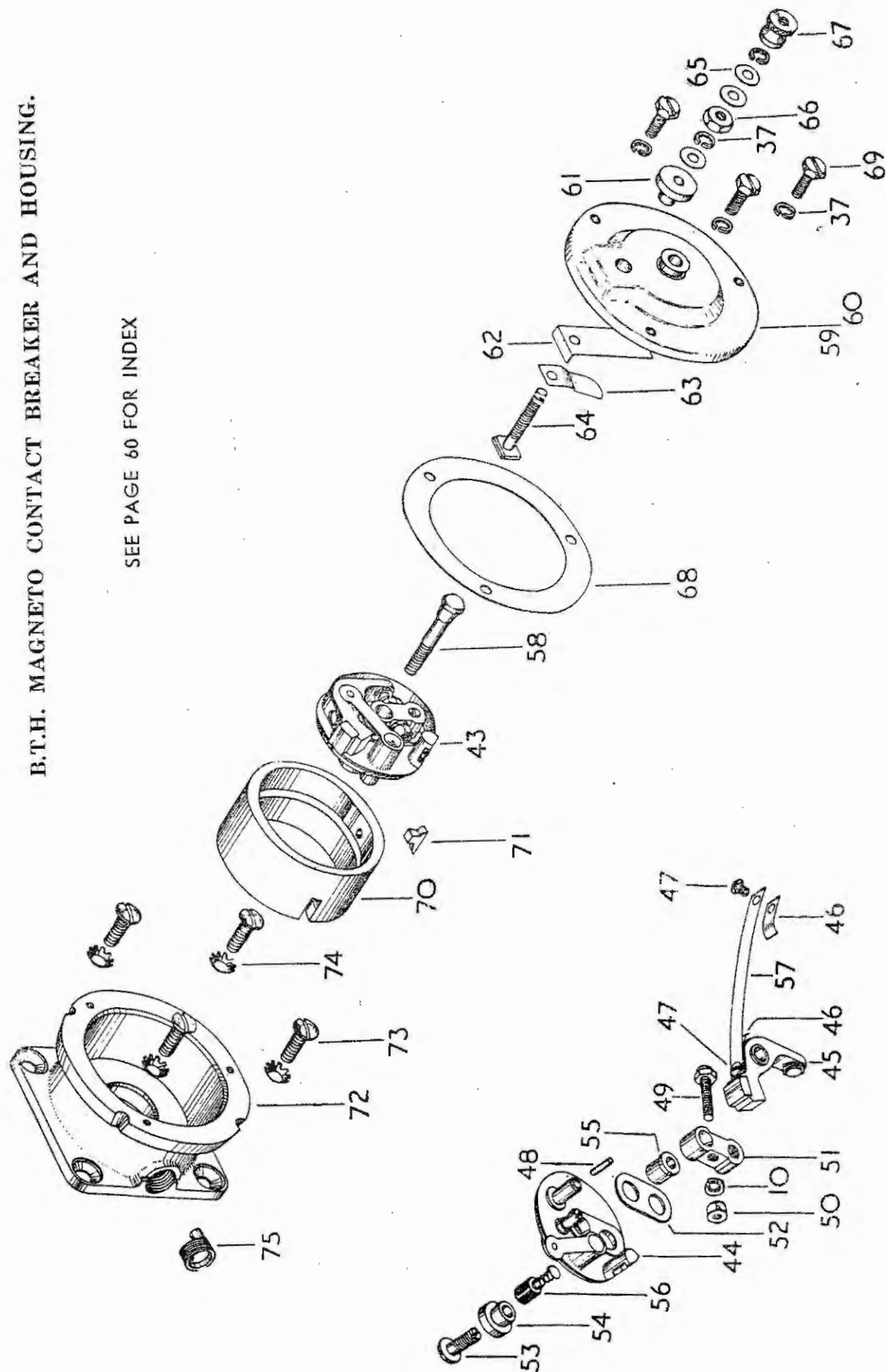

SKC35711-G2	Gear, auto advance	1	1	1	1
SKC33845-1	Plate, auto advance driving	1	1	1	1
SKC33847-1	Hub, auto advance	1	1	1	1
CR35704-1	Screw, plate to hub securing	5	5	5	5
CR35706-1	Roller, auto advance	5	5	5	5
CR35707-1	Spring, auto advance main	1	1	1	1
CR35709-1	Circlip, auto advance main spring	1	1	1	1
CR35705-1	Nut, auto advance securing	1	1	1	1

INDEX TO ILLUSTRATIONS ON PAGES 57, 58 AND 59

1. CZ87157-G2	26. CR35709-1	51. SKC6235-1
2. SKC741-G1	27. CR35705-1	52. SKC6213-1
3. SKC6123-1	28. CY50495-G1	53. SKC6209-1
4. CR22186-1	29. SKC6115-1	54. SKC6210-1
5. CR22315-1	30. SKC6111-1	55. SKC6212-1
6. CR23042-1	31. SKC6114-1	56. SKC6219-G1
7. SKC6245-1	32. SKC6112-1	57. SKC6214-1
8. SKC24291-1	33. CY52078-G3	58. CR27891-1
9. 3BA×5/16" Rd. Hd.	34. SKC6636-1	59. CZ61580-1
10. SKC9952-8	35. SKC6637-1	60. SKC28537-G2
11. CR23290-1	36. 4BA×5/16" Ch. Hd.	61. CR89533-1
12. SKC6799-1	37. SKC9952-6	62. CR29456-1
13. SKC87159-G1	38. CR20776-1	63. CR29455-1
14. SKC6306-G2	39. SKC6612-G1	64. CR29459-1
15. CR87404-1	40. SKC6122-1	65. 4BA Std. Br.
16. CR87160-1	41. SKC6180-1	66. CR26513
17. CZ60707-G19	42. CR20774-1	67. CR9849
18. SKC6397-1	43. CX1883-G24	68. CR28540-1
19. CR87403-1	44. SKC74955-G2	69. CR28571-1
20. SKC35711-G2	45. CZ63472-G2	70. SKC33650-4
21. SKC33845-1	46. SKC6215-1	71. SKC6344-1
22. SKC33847-1	47. SKC6208-1	72. SKC28544-G3
23. CR35704-1	48. CR29708-1	73. 2BA × 1/2" Inst. Hd.
24. CR35706-1	49. SKC29303-G1	74. SKC88939-20
25. CR35707-1	50. SKC6216-1	75. CR26381-1

SEE PAGE 64 FOR GASKET SETS.

LUCAS ELECTRICAL EQUIPMENT GROUP

DYNAMO

200,03A	Dynamo, complete	1	1	1	1
200,572	Armature assembly	1	1	1	1
200,270	Commutator end c/w bush	1	1	1	1
200,231	Bush, commutator end	1	1	1	1
200,354	Cover, commutator end	1	1	1	1
200,607	Bracket assembly, driving end	1	1	1	1
189,307	Ball-race, driving end	1	1	1	1
B2047	Seal, oil	1	1	1	1
200,609	Band, cover assembly	1	1	1	1
188,818	Nipple, cable fixing	2	2	2	2
200,598	Plate, clamp	1	1	1	1
115,850	Screw, clamp plate fixing	1	1	1	1
200,227	Bolt, through fixing	2	2	2	2
165,078	Nut, " " bolt	4	4	4	4
188,330	Washer, " " "	4	4	4	4
200,290	Brush set	1	1	1	1
200,079	Spring set, brush	1	1	1	1
189,386	Key, Woodruff	1	1	1	1
E2229	Pinion, dynamo	1	1	1	1
111,700	Screw, " pinion	1	1	1	1
188,378	Washer, " " screw	1	1	1	1
E2228	Nut (dome), dynamo to gearcase	1	1	1	1
E2414	Stud, dynamo fixing	1	1	1	1
E2226	Washer, " to crankcase joint	1	1	1	1
E2230	Strap, " fixing	1	1	1	1
	Swivel, " strap	2	2	2	2
	Screw, " "	2	2	2	2

CUT-OUT AND REGULATOR UNIT

33053A	Regulator, complete	1	1	1	1
390,380	Cover, cut-out	1	1	1	1
390,461	Clip, cover spring	1	1	1	1
390,386	Strap, regulator fixing	1	1	1	1

HEAD LAMP (D42CPR)

055,014	Headlamp	1	1	1	1
515,470	Shell headlamp	1	1	1	1
112,201	Screw, fixing headlamp	2	2	2	2
516,218	Rim only	1	1	1	1
516,199	Glass, fluted	1	1	1	1
516,047	Clasp, rim assembly	1	1	1	1
516,145	Reflector, c/w joint head, and fixing wires	1	1	1	1

FIGURE IN MODEL COLUMN DENOTES QUANTITY PER MACHINE.

PART NO.	DESCRIPTION	3T	T85	5T	T100
516,190	Wires, reflector fixing	4	4	4	4
MC309/6	Joint bead, reflector	1	1	1	1
515,191	Back shell assy. c/w main and pilot bulb holders ...	1	1	1	1
MB398/10	Fixing wire, back shell	1	1	1	1
504,801	Holder, main bulb	1	1	1	1
551,807	Clip and screw, main bulb holder	1	1	1	1
200	Bulb, pilot	1	1	1	1
70	Bulb, main	1	1	1	1

TAIL LAMP

530,09A	Tail lamp MT110	1	1	1	1
526,111	Base assembly, less bulb	1	1	1	1
526,112	Body assembly, with glass	1	1	1	1
200	Bulb	1	1	1	1
571,395	Connector	1	1	1	1
106,460	Screw, tail lamp	1	1	1	1
165,334	Nut, " " screw	1	1	1	1

CABLE HARNESS

982,221	Cable harness assembly	1	1	1	1
990,521	" " dynamo to regulator	1	1	1	1
858,022	" " regulator, horn and cut-out button ...	1	1	1	1

INSTRUMENT PANEL

F2091	Panel, instrument, MC8390/1	1	1	1	1
F2577	Screw, instrument panel fixing	1	1	1	1
F2445	Beading, instrument panel rubber	1	1	1	1
351,552	Switch, lighting	1	1	1	1
351,567	Lever, switch, with screw	1	1	1	1
560,23A	Lamp, instrument panel inspection	1	1	1	1
360,00A	Ammeter	1	1	1	1
F2472	Oil gauge	1	1	1	1
200	Bulb panel lamp	1	1	1	1

DIMMER SWITCH

380,057	Switch, dimmer	1	1	1	1
---------	-----------------------	---	---	---	---

BATTERY

PUW7E/4	Battery, 6 volt (dry)	1	1	1	1
S2263/4	Plug vent, c/w washer	3	3	3	3

HORN

701,404	Horn, Altette, HF1234	1	1	1	1
762,080	Push, horn button, 4A/CP	1	1	1	1
W76	Nut, horn fixing	1	1	1	1
S26-1	Washer, horn fixing	1	1	1	1

CUT-OUT BUTTON

762,080	Push, cut-out button, 4A/CP	1	1	1	1
---------	------------------------------------	---	---	---	---

TREASURY NOTES MUST BE REGISTERED.

PART NO.	DESCRIPTION	3T	T85	5T	T100
MAGNETO (LUCAS TYPE K2F-RO)					
421118	Magneto c/w auto advance ...	1	1	1	1
458333	Armature assembly ...	1	1	1	1
455361	Slip ring ...	1	1	1	1
189291	Bearing (C.B.E. and D.E.) ...	2	2	2	2
458339	Condenser assembly ...	1	1	1	1
458619	Cover, contact breaker ...	1	1	1	1
470534	Contact breaker assembly ...	1	1	1	1
122160	Screw, contact breaker fixing ...	1	1	1	1
470609	Contact breaker set ...	1	1	1	1
470688	Spring set ...	1	1	1	1
470537	Brush and spring, C.B. earth ...	1	1	1	1
458613	Spring pillar, C.B. cover securing ...	1	1	1	1
100020	Screw, C.B. end plate fixing ...	1	1	1	1
185037	Washer, " " " " ...	1	1	1	1
458355	Washer, " " " shim ...	1	1	1	1
458356	Washer, " " " " ...	1	1	1	1
458389	Cam assembly ...	1	1	1	1
458633	End plate assembly ...	1	1	1	1
465129	Cup, bearing, insulating ...	2	2	2	2
455191	Brush, spring and holder (mag. earth) ...	1	1	1	1
455190	Brush and spring ...	1	1	1	1
458370	Spring pin, pick up fixing ...	2	2	2	2
458375	Seal, rubber oil ...	1	1	1	1
458644	Pick up with brush and spring (LH) ...	1	1	1	1
458643	Pick up " " " (RH) ...	1	1	1	1
451260	Brush and spring, pick up ...	2	2	2	2
498152	Auto advance unit ...	1	1	1	1
498157	Spring, auto advance ...	2	2	2	2
415116	Spanner and point gauge ...	1	1	1	1

ENGINE NUMBER IS IMPRESSED ON DRIVING SIDE OF CRANKCASE.

GASKET SETS

Including all necessary Gaskets for decarbonising and front fork drain and pressure valve screw washers. Cylinder head and primary chaincase Gaskets are supplied separately.

GS350T/46 Gasket Set for 3T and T85

GS5T/46 " " " 5T

GST100/46 " " " T100

GEAR RATIOS

Engine Sprocket	STANDARD RATIO					WIDE RATIO			
	Top	3rd	2nd	1st		Top	3rd	2nd	1st
17	6.46	7.75	11.35	16.40		6.46	9.36	14.83	19.82
18	6.10	7.33	10.50	15.50		6.10	8.84	14.00	18.70
19	5.80	6.95	10.0	14.70		5.80	8.40	13.30	17.80
20	5.50	6.60	9.5	14.0		5.50	7.96	12.62	16.88
21	5.24	6.28	9.05	13.3		5.24	7.60	12.02	16.08
22	5.00	6.0	8.65	12.7		5.00	7.25	11.48	15.34
23	4.78	5.75	8.26	12.1		4.78	6.93	11.00	14.70
24	4.57	5.49	8.03	11.6		4.57	6.63	10.49	14.03
25	4.40	5.28	7.73	11.08		4.40	6.38	10.12	13.51

PARTS REQUIRED TO CONVERT

FROM STANDARD TO WIDE RATIO					FROM WIDE TO STANDARD RATIO				
T465	Mainshaft	High	Gear	... 16 6	T726	Mainshaft	High	Gear	... 15 0
T467	"	2nd	"	... 12 6	T727	"	2nd	"	... 10 6
T466	Layshaft	High	"	... 13 6	T434	Layshaft	High	"	... 12 6
T468	"	2nd	"	... 12 6	T436	"	2nd	"	... 11 6

COPY OF GUARANTEE GIVEN TO TRIUMPH DEALERS

WE do not appoint agents for the sale of our motor cycles or other goods. We assign to Motor Cycle Dealers, who carry on business on their own account, areas, in which they have the exclusive or other rights to sell goods purchased by them from us. A Dealer purchasing from us or a Sub-Dealer purchasing from him, may assign to his purchaser the benefit of the guarantee printed below. Any such dealer is not authorised to advertise, incur any debts, or transact any business whatsoever on our account; nor is he authorised, so as to bind us, to give any warranty or make any representation or make or agree to any condition on our behalf.

We give the following guarantee with our motor cycles, motor cycle combinations and sidecars, which is given in place of any conditions, warranties or liabilities whatsoever, implied by law, implied at the place of manufacture and/or at the place of sale, all such implied conditions, warranties, and liabilities being in all cases excluded. Any statement, description, condition or representation contained in our catalogue, or in any advertisement, leaflet or other publications shall not be construed as enlarging, varying or overriding this guarantee. In the case of machines which have been used for "hiring out" purposes, or any motor cycle and/or sidecar used for any dirt track, cinder track or grass track, racing or competitions (or any competition of any kind within an enclosure for which a charge is made for admission to take part in or view the competition), or from which our trade mark or manufacturing number has been removed, no warranty or condition of any kind is given or is to be implied.

We guarantee, subject to the conditions mentioned below, that all precautions which are usual and reasonable have been taken by us to secure excellence of materials and workmanship, but this guarantee is to extend and be in force for six months only from date of delivery and damages for which we make ourselves responsible under this guarantee are limited to the free supply of a new part in exchange for the part of the motor cycle, motor cycle combination or sidecar which may have proved defective. We do not undertake to replace or refix or bear the cost of replacing or refixing such new part in the motor cycle, motor cycle combination or sidecar. We undertake subject to the conditions mentioned below, to make good at any time within six months any defects in these respects. As motor cycles and motor cycle combinations are easily liable to derangement by neglect or misuse, this guarantee does not apply to defects caused by wear and tear, misuse or neglect.

The term "misuse" shall include amongst others the following acts:—

1. The attaching of a sidecar to a motor cycle in a manner calculated to cause damage or to render the latter unsafe when ridden.
2. The use of a motor cycle or a motor cycle and sidecar combined, when carrying more persons or a greater weight than that for which the machine was designed by the manufacturers.
3. The attaching of a sidecar to a motor cycle by any form of attachment not provided or supplied or approved by the manufacturers, or to a motor cycle which is not designed for such use.

Any motor cycle or motor cycle combination or sidecar sent to us to be plated, enamelled, or repaired will be repaired upon the following conditions, i.e., we guarantee that all precautions which are usual and reasonable have been taken by us to secure excellence of materials and workmanship, such guarantee to extend and be in force for three months only from the time such work shall have been executed or until the expiration of the six months, above referred to, and this guarantee is in lieu and in exclusion of any common or law statute, warranty or condition and the damages recoverable are limited to the cost of any further work which may be necessary to amend and make good the work found to be defective.

CONDITIONS OF GUARANTEE

If a defective part should be found in our motor cycles, motor cycle combinations or sidecars, or in any part supplied by way of exchange before referred to, it must be sent to us CARRIAGE PAID, and accompanied by an intimation from the sender that he desires to have it repaired or exchanged free of charge under our guarantee, and he must also furnish us at the same time with the number of the machine, the name of the Dealer from whom he purchased, and the date of purchase, or the date when the alleged defective part was exchanged as the case may be.

Failing compliance with the above, no notice will be taken of anything which may arrive, but such articles will lie here AT THE RISK OF THE SENDERS.

We guarantee only those machines which are bought either direct from us or from a Dealer, who has purchased direct from us, or from a Sub-Dealer who has purchased from his, and under no other condition.

We do not guarantee the specialities of other firms such as tyres, saddles, chains, lamps, etc., nor do we guarantee any component parts supplied to the order of the purchaser differing from our standard specifications supplied with our motor cycles, motor cycle combinations, sidecars, or otherwise.

British Only

MOTORCYCLES AND PARTS INC.

32451 PARKLANE ST. WWW.BRITISHONLY.COM
GARDEN CITY, MI 48135 USA INFO@BRITISHONLY.COM

RETAIL: 1-800-278-6659

WHOLESALE: 1-800-852-9253

FAX: 1-734-422-9253

WORLDS LARGEST SELECTION OF FACTORY ORIGINAL NEW AND USED PARTS

45,000 SQ. FT. OF MOTORCYCLE PARTS & ACCESSORIES FROM 1911 TO 1984 FOR ALL BRITISH MAKES!

CASH FOR ALL BRITISH BIKES, PARTS AND LITERATURE

SPECIALIZING IN
VINTAGE MOTORCYCLE PARTS

TRIUMPH

Norton

BSA

THE BIGGEST!

ENGINE REBUILDING PARTS
GASKET - SEALS - BEARINGS
BUSHINGS - PISTONS - RINGS
CLUTCHES - TUNE UP PARTS
SPEED EQUIPMENT

THE BEST!

STOCK AND CUSTOM PARTS
SEATS - HANDLEBARS - CHAINS
TIRES - TUBES - EXHAUST PIPES
MUFFLERS - GAS TANKS - FENDERS
RESTORATION PARTS

THE ONLY!

**Central Wheel
Components**

Barnett
Clutches & Cables

**CLASSIC
TRANSFERS**
ROBERT DERRICK LTD

RENOLD

Lucas

AMAL

IEMIGO
Your Powersport Supplier

BRITURO
ENGLAND

JP PISTONS

HASTINGS

UH

VELOCETTE • ANDOVER NORTON • TEC • HAYNES • P&P SEATING • WASSELL • MORG
ALPHA BEARINGS • M.A.C. PRODUCTS • JOE HUNT MAGNETOS • J.J. CABLES • BUCHANAN'S
L.A. SLEEVE • MEGACYCLE CAMS • T.J. WASSELL LIMITED • SUDCO INTERNATIONAL
ACE CLASSICS LONDON • CLASSIC GASKETS • BRITISH WIRING • PBM ENGINEERING
TRI-COR ENGLAND • LEAK PROOF SEALS • MCA (ASTON) LIMITED • GARDNER - WESTCOTT

WE ACCEPT VISA - MASTERCARD - DISCOVER - AMERICAN EXPRESS

PARTS SHIPPED WORLDWIDE !!!

VISA

MasterCard

Discover

**AMERICAN
EXPRESS**

VISIT OUR EBAY STORE

<http://stores.ebay.com/British-Only-Motorcycles-And-Parts>

British Only

MOTORCYCLES AND PARTS INC.

32451 PARKLANE ST. WWW.BRITISHONLY.COM
GARDEN CITY, MI 48135 USA INFO@BRITISHONLY.COM

RETAIL: 1-800-278-6659

WHOLESALE: 1-800-852-9253

FAX: 1-734-422-9253

WORLDS LARGEST SELECTION OF FACTORY ORIGINAL NEW AND USED PARTS

45,000 SQ. FT. OF MOTORCYCLE PARTS & ACCESSORIES FROM 1911 TO 1984 FOR ALL BRITISH MAKES!

CASH FOR ALL BRITISH BIKES, PARTS AND LITERATURE

SPECIALIZING IN
VINTAGE MOTORCYCLE PARTS

TRIUMPH

Norton

BSA

THE BIGGEST!

ENGINE REBUILDING PARTS
GASKET - SEALS - BEARINGS
BUSHINGS - PISTONS - RINGS
CLUTCHES - TUNE UP PARTS
SPEED EQUIPMENT

THE BEST!

STOCK AND CUSTOM PARTS
SEATS - HANDLEBARS - CHAINS
TIRES - TUBES - EXHAUST PIPES
MUFFLERS - GAS TANKS - FENDERS
RESTORATION PARTS

THE ONLY!

**Central Wheel
Components**

Barnett
Clutches & Cables

**CLASSIC
TRANSFERS**
ROBERT DERRICK LTD

RENOLD

Lucas

AMAL

IEMIGO
Your Powersport Supplier

BRITURO
ENGLAND

JP PISTONS

HASTINGS

U&I

VELOCETTE • ANDOVER NORTON • TEC • HAYNES • P&P SEATING • WASSELL • MORG
ALPHA BEARINGS • M.A.C. PRODUCTS • JOE HUNT MAGNETOS • J.J. CABLES • BUCHANAN'S
L.A. SLEEVE • MEGACYCLE CAMS • T.J. WASSELL LIMITED • SUDCO INTERNATIONAL
ACE CLASSICS LONDON • CLASSIC GASKETS • BRITISH WIRING • PBM ENGINEERING
TRI-COR ENGLAND • LEAK PROOF SEALS • MCA (ASTON) LIMITED • GARDNER - WESTCOTT

WE ACCEPT VISA - MASTERCARD - DISCOVER - AMERICAN EXPRESS

PARTS SHIPPED WORLDWIDE !!!

VISA

MasterCard

Discover

**AMERICAN
EXPRESS**

VISIT OUR EBAY STORE

<http://stores.ebay.com/British-Only-Motorcycles-And-Parts>

FOLD

Name _____

Address _____

City _____

State _____ Zip _____

USE
FIRST CLASS
LETTER
POSTAGE

British Only
MOTORCYCLES AND PARTS INC.
32451 PARKLANE ST
GARDEN CITY, MI 48135 USA

FOLD
